



TRUS JOIST®

TJI® 110 ■ TJI® 210

TJI® 360 ■ TJI® 560

JOISTS

Featuring Silent Floor® Joists for Residential Applications

- Uniform and Predictable
- Lightweight for Fast Installation
- Resource Efficient
- Resists Bowing, Twisting, and Shrinking
- Significantly Reduces Callbacks
- Available in Long Lengths
- Includes Product Warranty



#TJ-4001 SPECIFIER'S GUIDE

www.iLevel.com
1.888.iLevel8 (1.888.453.8358)

 Weyerhaeuser

WELCOME TO iLEVEL

iLevel is an exciting new brand and business within Weyerhaeuser. iLevel brings the most innovative and trusted products for residential construction together under one roof. Within iLevel, you'll still find all the reliable, brand-name building products that you've been

using—Trus Joist® engineered wood products and design software, Structurwood® engineered panels, Performance Tested™ lumber, and more. But with iLevel, you'll work with only one service-oriented supplier to get all of these products and the support you need to build smarter.

iLevel. A family of brand-name building products . . . a source for innovative ideas and solutions . . . a supplier that's simpler to do business with.

TJI® Joists Revolutionized the Way You Build Floors

Trus Joist® developed wooden I-joists nearly 40 years ago, and since then we've continually improved their quality and made them easier to work with. Engineered to provide strength and consistency, iLevel™ Trus Joist® Silent Floor® joists (TJI® joists) are a key part of our Frameworks® Floor system.

Here's Why So Many Specifiers and Builders Choose Silent Floor® joists:

Design flexibility—longer lengths mean versatile design options.

Silent Floor® joists continue to set the standard for residential floor and roof joists. Their strength and long lengths give you the freedom to design the open, spacious floor plans that your customers want. Engineered for dimensional stability and predictable performance, Silent Floor® joists resist warping, twisting, and shrinking.

Easy installation—fewer surprises on the job. The precision engineering that makes Silent Floor® joists strong also makes them easier to install. Silent Floor® joists are designed for easy handling and fast installation. They are lightweight, easy to cut, and can be installed using standard construction tools. Silent Floor® joists come with precut knock-out holes, and additional holes for ductwork can be cut at the jobsite. These same features also make them a popular choice for roof joists.

TABLE OF CONTENTS

Design Properties	3
Material Weights	3
Floor Span Tables	4
Floor Load Tables	5
PSF to PLF Conversion Table	5
Floor Performance	6
FrameWorks® Floor System	7
Silent Floor® Joist Framing	8
Joist Nailing Requirements	8
Floor Details	9
Fastening of Floor Panels	9
Rim Board Selection and Installation	10
Allowable Holes	11
Cantilevers	12–13
Fire-Safe Construction	14
Understanding and Preventing Floor Noise	15
Roof Span Table	16–17
Roof Span Notes and Cut Length Calculation	17
Roof Framing	18
Roof Details	19–20
Roof Load Tables	21
Framing Connectors	22–23

The residential products in this guide are intended for use in single-family dwellings and are readily available through our nation-wide network of distributors and dealers. For information on using these products in multi-family dwellings, contact your iLevel representative.

For commercial applications such as retail stores, office buildings, schools, restaurants, hotels, and nursing homes, please refer to the *TJI® L65, L90, H90 Joist Commercial Design Guide* (Reorder #1062). Commercial products are typically designed, manufactured, and sold for each specific job.

For more information on any iLevel™ product, please call 1-888-453-8358.

Design Properties (100% Load Duration)

Depth	TJI®	Basic Properties				Reaction Properties		
		Joist Weight (lbs/ft)	Maximum Resistive Moment ⁽¹⁾ (ft-lbs)	Joist Only EI x 10 ⁶ (in. ² -lbs)	Maximum Vertical Shear (lbs)	1¾" End Reaction (lbs)	3½" Intermediate Reaction (lbs)	
							No Web Stiffeners	With Web Stiffeners
9½"	110	2.3	2,380	140	1,220	885	1,935	N.A.
	210	2.6	2,860	167	1,330	980	2,145	N.A.
11⅞"	110	2.5	3,015	238	1,560	885	1,935	2,295
	210	2.8	3,620	283	1,655	980	2,145	2,505
	360	3.0	6,180	419	1,705	1,080	2,460	2,815
	560	4.0	9,500	636	2,050	1,265	3,000	3,475
14"	110	2.8	3,565	351	1,860	885	1,935	2,295
	210	3.1	4,280	415	1,945	980	2,145	2,505
	360	3.3	7,335	612	1,955	1,080	2,460	2,815
	560	4.2	11,275	926	2,390	1,265	3,000	3,475
16"	210	3.3	4,895	566	2,190	980	2,145	2,505
	360	3.5	8,405	830	2,190	1,080	2,460	2,815
	560	4.5	12,925	1,252	2,710	1,265	3,000	3,475

(1) **Caution:** Do not increase joist moment design properties by a repetitive member use factor.

TJI® joists are intended for dry-use applications

General Notes

- Design reaction includes all loads on the joist. Design shear is computed at the inside face of supports and includes all loads on the span(s). Allowable shear may sometimes be increased at interior supports in accordance with ICC ES ESR-1153, and these increases are reflected in span tables.
- The following formulas approximate the uniform load deflection of Δ (inches):

For
TJI® 110, 210, and 360 Joists

$$\Delta = \frac{22.5 wL^4}{EI} + \frac{2.67 wL^2}{d \times 10^5}$$

w = uniform load in pounds per linear foot
L = span in feet
d = out-to-out depth of the joist in inches
EI = value from table above

For
TJI® 560 Joists

$$\Delta = \frac{22.5 wL^4}{EI} + \frac{2.29 wL^2}{d \times 10^5}$$

Code Evaluations: ICC ES ESR-1153 and ICC ES ESR-1387

Material Weights

(Include TJI® weights in dead load calculations—see **Design Properties** table at left for joist weights)

Floor Panels

Southern Pine

½" plywood	1.7 psf
⅝" plywood	2.0 psf
¾" plywood	2.5 psf
1⅛" plywood	3.8 psf
½" OSB	1.8 psf
⅝" OSB	2.2 psf
¾" OSB	2.7 psf
⅞" OSB	3.1 psf
1⅛" OSB	4.1 psf

Based on: Southern pine – 40 pcf for plywood, 44 pcf for OSB

Roofing

Asphalt shingles	2.5 psf
Wood shingles	2.0 psf
Clay tile	9.0 to 14.0 psf
Slate (¾" thick)	15.0 psf

Roll or Batt Insulation (1" thick):

Rock wool	0.2 psf
Glass wool	0.1 psf

Floor Finishes

Hardwood (nominal 1")	4.0 psf
Sheet vinyl	0.5 psf
Carpet and pad	1.0 psf
¾" ceramic or quarry tile	10.0 psf

Concrete:

Regular (1")	12.0 psf
Lightweight (1")	8.0 to 10.0 psf
Gypsum concrete (¾")	6.5 psf

Ceilings

Acoustical fiber tile	1.0 psf
½" gypsum board	2.2 psf
⅝" gypsum board	2.8 psf
Plaster (1" thick)	8.0 psf

Not all products are available in all markets. Contact your iLevel representative for information.

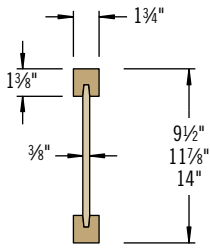

TJI® 110 Joists

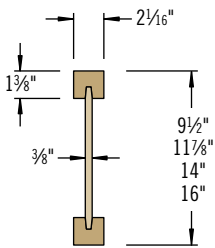

TJI® 210 Joists

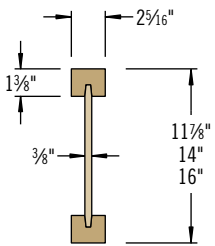

TJI® 360 Joists

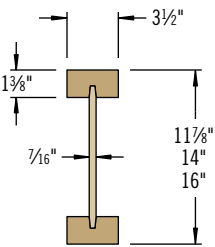

TJI® 560 Joists

L/480 Live Load Deflection

Depth	TJI®	40 PSF Live Load / 10 PSF Dead Load				40 PSF Live Load / 20 PSF Dead Load			
		12" o.c.	16" o.c.	19.2" o.c.	24" o.c.	12" o.c.	16" o.c.	19.2" o.c.	24" o.c.
9 1/2"	110	16'-5"	15'-0"	14'-2"	13'-2"	16'-5"	15'-0"	13'-11"	12'-5"
	210	17'-3"	15'-9"	14'-10"	13'-10"	17'-3"	15'-9"	14'-10"	13'-8"
11 7/8"	110	19'-6"	17'-10"	16'-10"	15'-5" ⁽¹⁾	19'-6"	17'-3"	15'-8"	14'-0" ⁽¹⁾
	210	20'-6"	18'-8"	17'-8"	16'-5"	20'-6"	18'-8"	17'-3"	15'-5" ⁽¹⁾
	360	22'-11"	20'-11"	19'-8"	18'-4"	22'-11"	20'-11"	19'-8"	17'-10" ⁽¹⁾
	560	26'-1"	23'-8"	22'-4"	20'-9"	26'-1"	23'-8"	22'-4"	20'-9" ⁽¹⁾
14"	110	22'-2"	20'-3"	18'-9"	16'-9" ⁽¹⁾	21'-8"	18'-9"	17'-1" ⁽¹⁾	14'-7" ⁽¹⁾
	210	23'-3"	21'-3"	20'-0"	18'-4" ⁽¹⁾	23'-3"	20'-7"	18'-9" ⁽¹⁾	16'-2" ⁽¹⁾
	360	26'-0"	23'-8"	22'-4"	20'-9" ⁽¹⁾	26'-0"	23'-8"	22'-4" ⁽¹⁾	17'-10" ⁽¹⁾
	560	29'-6"	26'-10"	25'-4"	23'-6"	29'-6"	26'-10"	25'-4" ⁽¹⁾	20'-11" ⁽¹⁾
16"	210	25'-9"	23'-6"	22'-0" ⁽¹⁾	19'-5" ⁽¹⁾	25'-5"	22'-0" ⁽¹⁾	20'-1" ⁽¹⁾	16'-2" ⁽¹⁾
	360	28'-9"	26'-3"	24'-8" ⁽¹⁾	21'-5" ⁽¹⁾	28'-9"	26'-3" ⁽¹⁾	22'-4" ⁽¹⁾	17'-10" ⁽¹⁾
	560	32'-8"	29'-8"	28'-0"	25'-2" ⁽¹⁾	32'-8"	29'-8"	26'-3" ⁽¹⁾	20'-11" ⁽¹⁾

L/360 Live Load Deflection (Minimum Criteria per Code)

Depth	TJI®	40 PSF Live Load / 10 PSF Dead Load				40 PSF Live Load / 20 PSF Dead Load			
		12" o.c.	16" o.c.	19.2" o.c.	24" o.c.	12" o.c.	16" o.c.	19.2" o.c.	24" o.c.
9 1/2"	110	18'-2"	16'-7"	15'-3"	13'-8"	17'-8"	15'-3"	13'-11"	12'-5"
	210	19'-1"	17'-5"	16'-6"	15'-0"	19'-1"	16'-9"	15'-4"	13'-8"
11 7/8"	110	21'-7"	18'-11"	17'-3"	15'-5" ⁽¹⁾	19'-11"	17'-3"	15'-8"	14'-0" ⁽¹⁾
	210	22'-8"	20'-8"	18'-11"	16'-10"	21'-10"	18'-11"	17'-3"	15'-5" ⁽¹⁾
	360	25'-4"	23'-2"	21'-10"	20'-4" ⁽¹⁾	25'-4"	23'-2"	21'-10"⁽¹⁾	17'-10" ⁽¹⁾
	560	28'-10"	26'-3"	24'-9"	23'-0"	28'-10"	26'-3"	24'-9"	20'-11" ⁽¹⁾
14"	110	23'-9"	20'-6"	18'-9"	16'-9" ⁽¹⁾	21'-8"	18'-9"	17'-1" ⁽¹⁾	14'-7" ⁽¹⁾
	210	25'-8"	22'-6"	20'-7"	18'-4" ⁽¹⁾	23'-9"	20'-7"	18'-9" ⁽¹⁾	16'-2" ⁽¹⁾
	360	28'-9"	26'-3"	24'-9" ⁽¹⁾	21'-5" ⁽¹⁾	28'-9"	26'-3"⁽¹⁾	22'-4" ⁽¹⁾	17'-10" ⁽¹⁾
	560	32'-8"	29'-9"	28'-0"	25'-2" ⁽¹⁾	32'-8"	29'-9"	26'-3"⁽¹⁾	20'-11" ⁽¹⁾
16"	210	27'-10"	24'-1"	22'-0" ⁽¹⁾	19'-5" ⁽¹⁾	25'-5"	22'-0" ⁽¹⁾	20'-1" ⁽¹⁾	16'-2" ⁽¹⁾
	360	31'-10"	29'-0"	26'-10" ⁽¹⁾	21'-5" ⁽¹⁾	31'-10"	26'-10"⁽¹⁾	22'-4" ⁽¹⁾	17'-10" ⁽¹⁾
	560	36'-1"	32'-11"	31'-0" ⁽¹⁾	25'-2" ⁽¹⁾	36'-1"	31'-6"⁽¹⁾	26'-3" ⁽¹⁾	20'-11" ⁽¹⁾

Long term deflection under dead load, which includes the effect of creep, has not been considered. **Bold italic** spans reflect initial dead load deflection exceeding 0.33".

(1) Web stiffeners are required at intermediate supports of continuous-span joists when the intermediate bearing length is *less* than 5 1/4" and the span on either side of the intermediate bearing is greater than the following spans:

TJI®	40 PSF Live Load / 10 PSF Dead Load				40 PSF Live Load / 20 PSF Dead Load			
	12" o.c.	16" o.c.	19.2" o.c.	24" o.c.	12" o.c.	16" o.c.	19.2" o.c.	24" o.c.
110	N.A.	N.A.	N.A.	15'-4"	N.A.	N.A.	16'-0"	12'-9"
210	N.A.	N.A.	21'-4"	17'-0"	N.A.	21'-4"	17'-9"	14'-2"
360	N.A.	N.A.	24'-5"	19'-6"	N.A.	24'-5"	20'-4"	16'-3"
560	N.A.	N.A.	29'-10"	23'-10"	N.A.	29'-10"	24'-10"	19'-10"

How to Use These Tables

1. Determine the appropriate live load deflection criteria.
2. Identify the live and dead load condition.
3. Select on-center spacing.
4. Scan down the column until you meet or exceed the span of your application.
5. Select TJI® joist and depth.

General Notes

- Tables are based on:
 - Uniform loads.
 - More restrictive of simple or continuous span.
 - Clear distance between supports (1 3/4" minimum end bearing).
- Assumed composite action with a single layer of 24" on-center span-rated, glue-nailed floor panels for deflection only. **Spans shall be reduced 6" when floor panels are nailed only.**
- Spans generated from iLevel™ software may exceed the spans shown in these tables because software reflects actual design conditions.
- For loading conditions not shown, refer to software or to load tables on page 5.

Live load deflection is not the only factor that affects how a floor will perform. To more accurately predict floor performance, use our TJ-Pro™ Rating System.

Floor—100% (PLF)

Depth	TJI®	Joist Clear Span																	
		8'		10'		12'		14'		16'		18'		20'		22'		24'	
		Live Load L/480	Total Load	Live Load L/480	Total Load	Live Load L/480	Total Load	Live Load L/480	Total Load	Live Load L/480	Total Load	Live Load L/480	Total Load	Live Load L/480	Total Load	Live Load L/480	Total Load	Live Load L/480	Total Load
9½"	110	*	190	127	152	77	127	50	95										
	210	*	210	147	169	90	141	59	114	40	81								
11⅞"	110	*	190	*	152	*	127	83	109	57	92								
	210	*	210	*	169	*	141	97	121	67	106	48	87						
	360	*	241	*	193	*	162	136	139	95	121	69	108	51	97	39	78		
	560	*	294	*	236	*	197	*	169	138	148	101	132	76	119	58	108	45	91
14"	110	*	190	*	152	*	127	*	109	83	95	59	85						
	210	*	210	*	169	*	141	*	121	96	106	69	94	51	84				
	360	*	241	*	193	*	162	*	139	*	121	98	108	73	97	56	88	44	81
	560	*	294	*	236	*	197	*	169	*	148	*	132	107	119	83	108	65	99
16"	210	*	210	*	169	*	141	*	121	*	106	93	94	69	85	53	77		
	360	*	241	*	193	*	162	*	139	*	121	*	108	*	97	75	88	59	81
	560	*	294	*	236	*	197	*	169	*	148	*	132	*	119	*	108	86	99

*Indicates **TOTAL LOAD** value controls.

How to Use This Table

1. Calculate actual total and live load in pounds per linear foot (plf).
2. Select appropriate **Joist Clear Span**.
3. Scan down the column to find a TJI® joist that meets or exceeds actual total and live loads.

General Notes

- Table is based on:
 - Uniform loads.
 - No composite action provided by sheathing.
 - More restrictive of simple or continuous span.
- **Total Load** limits joist deflection to L/240.
- **Live Load** is based on joist deflection of L/480.
- If a live load deflection limit of L/360 is desired, multiply value in **Live Load** column by 1.33. The resulting live load shall not exceed the **Total Load** shown.

PSF to PLF Conversions

O.C. Spacing	Load in Pounds Per Square Foot (PSF)								
	20	25	30	35	40	45	50	55	60
Load in Pounds Per Linear Foot (PLF)									
12"	20	25	30	35	40	45	50	55	60
16"	27	34	40	47	54	60	67	74	80
19.2"	32	40	48	56	64	72	80	88	96
24"	40	50	60	70	80	90	100	110	120



DO NOT allow workers to walk on joists until braced. **INJURY MAY RESULT.**

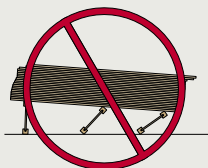

DO NOT stack building materials on unbraced joists. **Stack only over beams or walls.**

WARNING

Joists are unstable until braced laterally

Bracing Includes:

- Blocking
- Hangers
- Rim Board
- Sheathing
- Rim Joist
- Strut Lines

WARNING NOTES: Lack of proper bracing during construction can result in serious accidents. Under normal conditions if the following guidelines are observed, accidents will be avoided.

1. All blocking, hangers, rim boards, and rim joists at the end supports of the TJI® joists must be completely installed and properly nailed.
2. Lateral strength, like a braced end wall or an existing deck, must be established at the ends of the bay. This can also be accomplished by a temporary or permanent deck (sheathing) fastened to the first 4 feet of joists at the end of the bay.
3. Safety bracing lines of 1x4 (minimum) must be nailed to a braced end wall or sheathed area (as in note 2) and to each joist. Without this bracing, buckling sideways or rollover is highly probable under light construction loads—like a worker or one layer of unnailed sheathing.
4. Sheathing must be totally attached to each TJI® joist before additional loads can be placed on the system.
5. Ends of cantilevers require safety bracing on both the top and bottom flanges.
6. The flanges must remain straight within a tolerance of ½" from true alignment.

It's About Choice—

The TJ-Pro™ Rating System is a sophisticated computer model for predicting floor performance and evaluating the relationship between the cost and the “feel” of any given floor system. Its methodology is based on extensive laboratory research, more than one million installations, and the combined expertise of the best engineers in the field. TJ-Pro™ Rating goes beyond deflection criteria to consider job-specific needs and expectations. In many cases, TJ-Pro™ Rating will offer a system that improves performance while actually reducing costs!

TJ-Pro™ Rating System Advantages:

- Works as part of iLevel™ TJ-Beam® and TJ-Xpert® software.
- Provides a new method for accurately predicting floor performance.
- Takes perceptions of the homeowner into account.
- Provides cost comparison.

Perceived Floor Performance

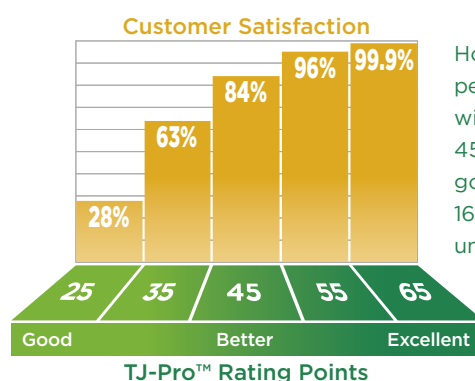

Design Smarter—Don't Over-Specify

The traditional way to specify a floor system is to use live load deflection criteria, but deflection explains only part of how a floor performs. Depending on factors unique to the structure and its use, the code minimum of L/360 (or even the more restrictive limits of L/480) may disappoint many customers.

The TJ-Pro™ Rating System is a much better predictor of floor performance because it considers the many factors that affect floor performance, even taking into account the perceptions of the homeowner. With so many variables, you can deliver an economical solution tailored to your customer's expectations.

Factors That Affect Floor Performance:

- TJI® joist series, depth, and spacing
- Deck thickness and quality
- Directly applied ceilings
- Location of partitions on floor
- Blocking
- Bearing conditions for the TJI® joists

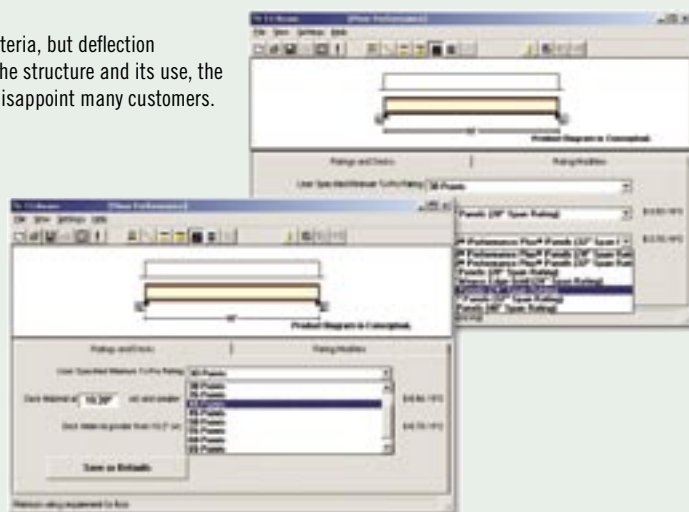

Get the Support You Need—

We're here to help you make the most of the TJ-Pro™ Rating System, whether it's help with setup, tips and tricks, or selecting the best rating for your project. Call your iLevel representative today.

The iLevel™ Trus Joist® FrameWorks® Floor System The Premium Floor System From iLevel

**You'll Like the Way it Builds.
Your Customers Will Love the Way it Feels.**

Design Your Floors to Suit Each Customer

With the TJ-Pro™ Rating System and iLevel's proprietary materials, we can accurately predict what it will take to build a floor that satisfies even your most demanding customer. And you'll get the right balance of cost and performance in every system.

Fewer Callbacks and More Referrals

Satisfied customers mean more referrals. And the FrameWorks® Floor System is the best way to make sure that there's less to complain about. It takes the guesswork out of how to build a floor that will make your customers happy.



Better Tile and Hardwood Performance

Our unique panel provides increased stiffness, better fastener holding, and lower edge swell than commodity panels, so it's ideal for hardwood and ceramic tile applications.

Faster and Easier Installation

The iLevel™ Trus Joist® TJ-Performance Plus® panels will save you time. The precise fastening template makes it easy to get it right the first time, and the self-gapping tongue and groove lets your crews slide the panels into place quickly.

Now You Can Build a Strong and Stable Floor—Without Overbuilding.



The performance of most commodity building products is unpredictable. But since we know the precise strength of every component in the FrameWorks® Floor System, we can comfortably build to your specifications while making sure that you don't use more material than you need.

Silent Floor® joists have very specific performance characteristics. TJ-Performance Plus® panels are made with a proprietary formula, meet precise thickness tolerances, and have a top-quality edge seal—making them more stable and consistent than other structural panels. iLevel™ Trus Joist®

rim board, e-Rim® board, beams, and columns made of TimberStrand® LSL, Parallam® PSL, and Microllam® LVL, and our helpful installation guidelines give you more control, more strength, and more reliability than you could get with a package made up of typical framing materials.

So next time you're building someone's dream home, don't rely on guesswork. Bring your plans to any iLevel location and we'll show you how to make the most of both your framing material and the labor it takes to turn it into a home.

***For projects that demand quality, performance, and customer satisfaction, upgrade to the FrameWorks® Floor System.
Contact your iLevel representative or call 1-888-453-8358 for more information.***

SILENT FLOOR® JOIST FRAMING

Silent Floor® joist framing does not require bridging or mid-span blocking

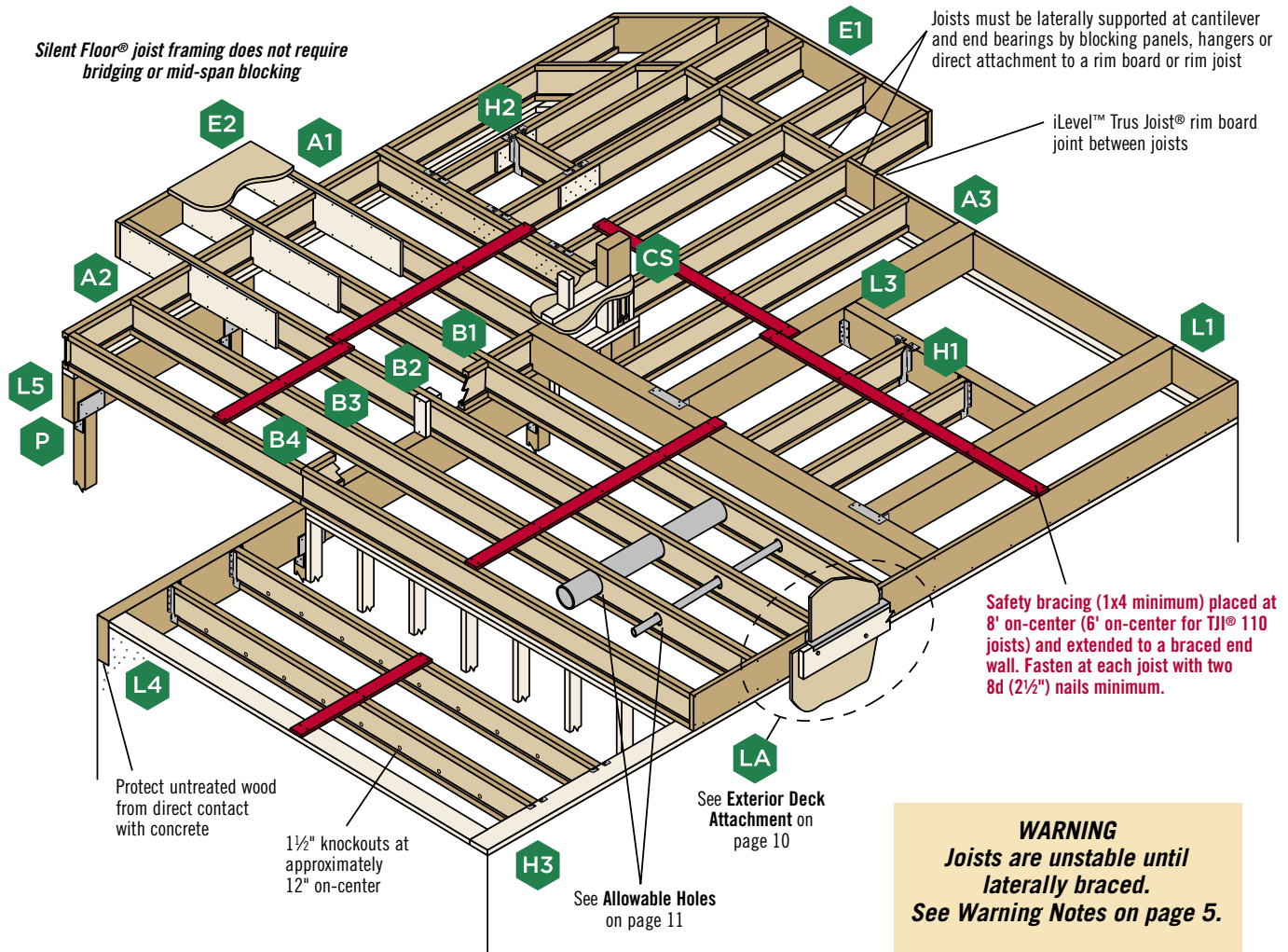

TJI® Joist Nailing Requirements at Bearing

TJI® Joist to Bearing Plate

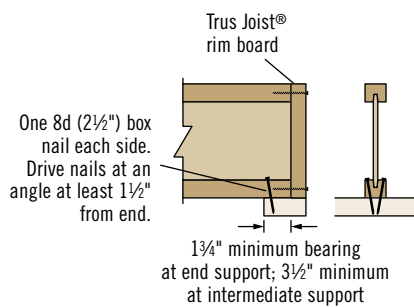

Shear transfer: Connections equivalent to floor panel nailing schedule

Squash Blocks to TJI® Joist (Load bearing wall above)

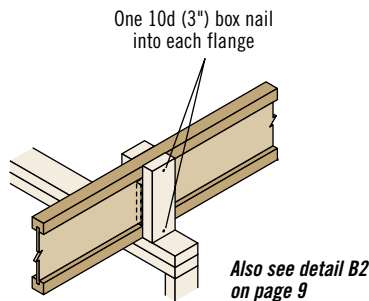

Web Stiffener Attachment

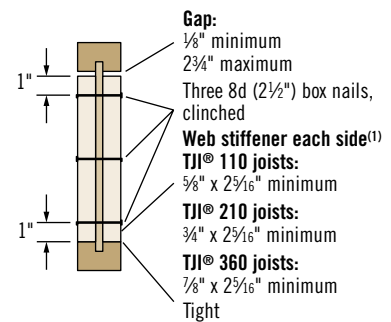

TJI® 560 Joists Only

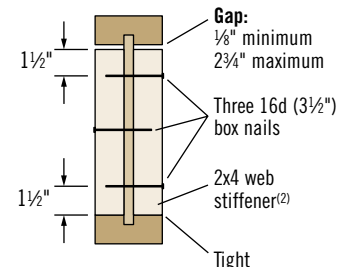

⁽¹⁾ Web stiffener material shall be PS1 or PS2 sheathing, face grain vertical

⁽²⁾ Construction grade or better

Rim to TJI® Joist

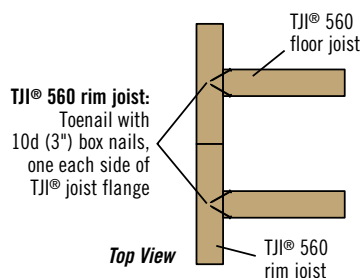
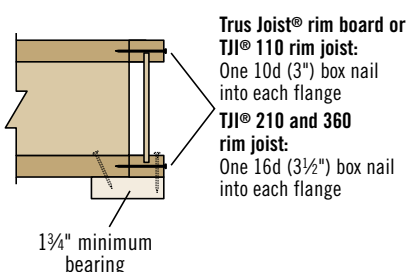

Load bearing or shear wall above
(must stack over wall below)

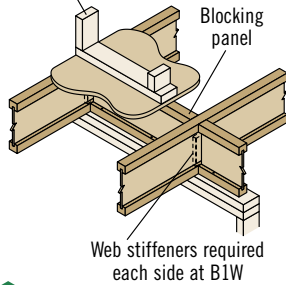

B1 **B1W**

Load bearing wall above
(must stack over wall below)

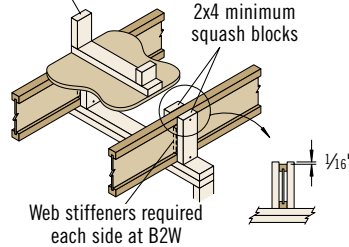

B2 **B2W**

Blocking panels may be required
with shear walls above or below—
see detail B1

Intermediate Bearing – No Load Bearing Wall Above

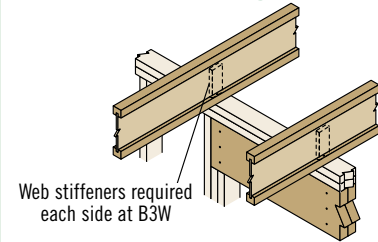

B3 **B3W**

Blocking panels may be required
with shear walls above or below—
see detail B1

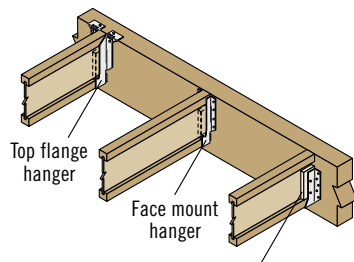

H1

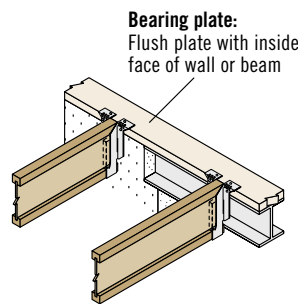

H3

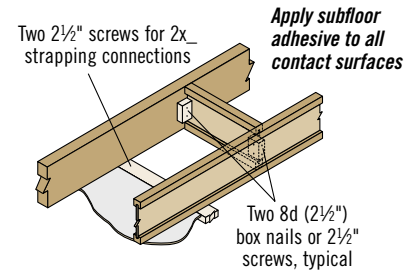

PB1

Applications shown in this guide do not require
blocking, strapping, or a directly applied ceiling.
However, backspan bracing of cantilever appli-
cations is required when specified by software.

Backer block: Install tight to top
flange (tight to bottom flange with
face mount hangers). Attach
with ten 10d (3")
box nails, clinched
when possible.

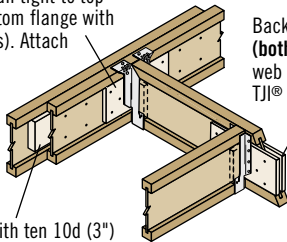

Backer block
(both sides)
of web with single
TJI joist

Filler block: Nail with ten 10d (3")
box nails, clinched. Use ten 16d (3 1/2") box
nails from each side with TJI 560 joists.

H2

With top flange hangers, backer block required only
for downward loads exceeding 250 lbs or for uplift
conditions

Filler and Backer Block Sizes

TJI®	110		210		360		560	
Depth	9 1/2" or 11 1/8"	14"	9 1/2" or 11 1/8"	14" or 16"	9 1/2" or 11 1/8"	14" or 16"	11 1/8"	14" or 16"
Filler Block ⁽¹⁾ (Detail H2)	2x6	2x8	2x6 + 3/8" sheathing	2x8 + 3/8" sheathing	2x6 + 1/2" sheathing	2x8 + 1/2" sheathing	Two 2x6	Two 2x8
Cantilever Filler (Detail E4)	2x6 4'-0" long	2x10 6'-0" long	2x6 + 3/8" sheathing 4'-0" long	2x10 + 3/8" sheathing 6'-0" long	2x6 + 1/2" sheathing 4'-0" long	2x10 + 1/2" sheathing 6'-0" long	Not applicable	
Backer Block ⁽¹⁾ (Detail F1 or H2)	5/8" or 3/4"		3/4" or 7/8"		1" net		2x6	2x8

(1) If necessary, increase filler and backer block height for face mount hangers and maintain 1/8" gap at top of joist. See detail W. Filler and backer block dimensions should accommodate required nailing without splitting. The suggested minimum length is 24" for filler and 12" for backer blocks.

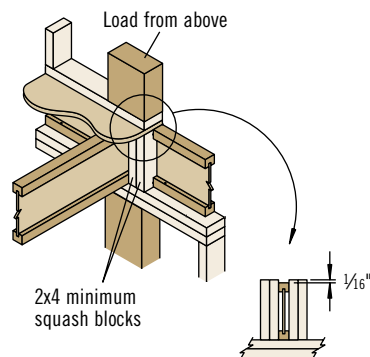

CS

Use 2x4 minimum squash blocks to transfer
load around TJI joist

Fastening of Floor Panels to TJI® Joist Flanges and Trus Joist® Rim Board

Nail Size	Closest On-Center Spacing per Row			
	TJI®		Trus Joist® Rim Board	
	110 and 210	360 and 560	1"	1 1/4"
8d (2 1/2") box	2 1/2"	2"	6"	4"
8d (2 1/2") common	3 1/2"	2"	6"	4"
10d (3"), 12d (3 1/4") box	3"	2"	6"	4"
10d (3"), 12d (3 1/4") common	4 1/2"	3"	6"	4"
16d (3 1/2") common	N.A.	4"	16"	6" ⁽¹⁾

(1) Can be reduced to 4" on-center with maximum nail penetration of 1 3/8" into the narrow edge.

General Notes

- Maximum spacing of nails is 18" on-center for TJI® 110 joists, and 24" on-center for TJI® 210, 360, and 560 joists.
- If more than one row of nails is used, the rows must be offset at least 1/2" and staggered.
- 14 ga. staples may be substituted for 8d (2 1/2") nails if minimum penetration of 1" is achieved.
- Table also applies for the attachment of TJI® rim joists and blocking panels to the wall plate.

Also see nailing requirements on page 8

RIM BOARD SELECTION AND INSTALLATION

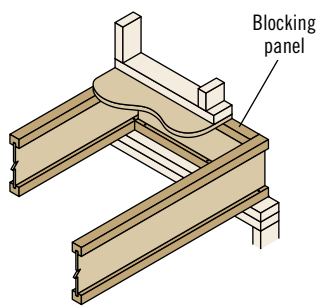

A1

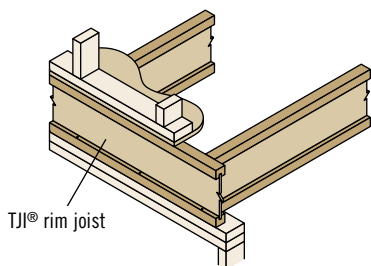

A2

Exterior Deck Attachment

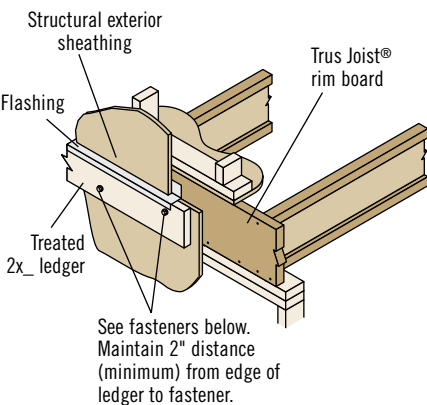

LA

Fastener	Allowable Load (lbs) ⁽¹⁾	
	1 1/4" Rim Board	1" e-Rim® Rim Board
3/8" lag bolt	400	N.A.
1/2" lag bolt	475	325

(1) Allowable load determined in accordance with AC 124.

■ Corrosion-resistant fasteners required for wet-service applications.

Rim board is often the critical structural link in the ability of a home to resist lateral wind loads. It also transfers vertical load around the TJI® joists.

Rim board detail A3 (shown below) satisfies conventional construction requirements. But if your project requires a designed solution, see our iLevel **Rim Board Selection and Installation Guide for Lateral Wind Loads** (Reorder #2109). This easy-to-use design guide for specifiers and code officials goes beyond conventional construction guidelines—which were based on the smaller, simpler homes of the past—and provides design information that considers today's larger, more complex homes.

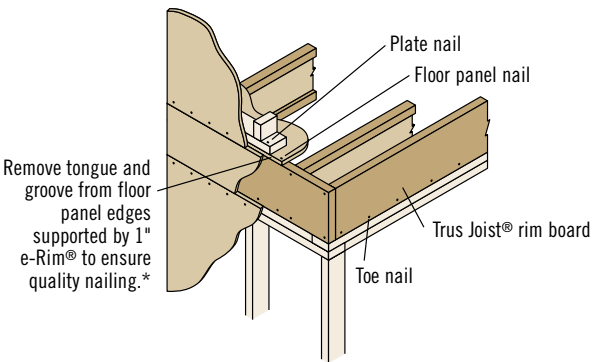

A3
A3.1
A3.2
A3.3

*According to ICBO Evaluation Services, Inc., it is necessary to trim the panel edges when using 1 1/8" or thinner rim board.

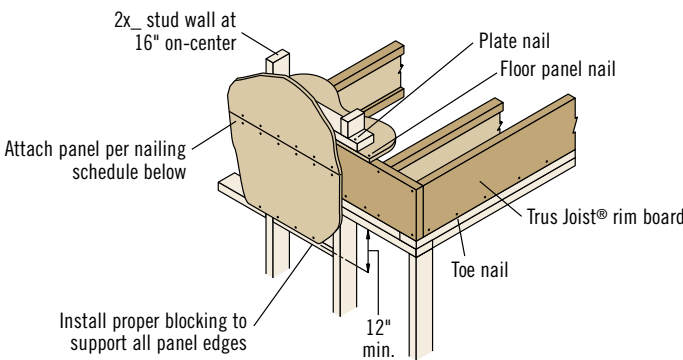

A3.4

Rim Board Installation

Specifications	A3 Conventional Construction, Code Minimum	A3.1, A3.2, A3.3, A3.4 Designed Solution
Rim Board Thickness	1" or 1 1/4"	See the iLevel <i>Rim Board Selection and Installation Guide for Lateral Wind Loads</i> (Reorder #2109)
Plate Nail—16d (3 1/2") box	16" o.c.	
Floor Panel Nail—8d (2 1/2") common	6" o.c.	
Toe Nail—10d (3") box	6" o.c.	
Sill Plate Anchor Bolt	1/2" dia. at 6' o.c.	

Vertical Load Transfer at Bearing

Allowable Uniform Vertical Loads (PLF)	
TJI® rim joist or blocking	2,100
Trus Joist® rim board or blocking	4,250

Loads may not be increased for duration of load.

Also see nailing requirements on page 8

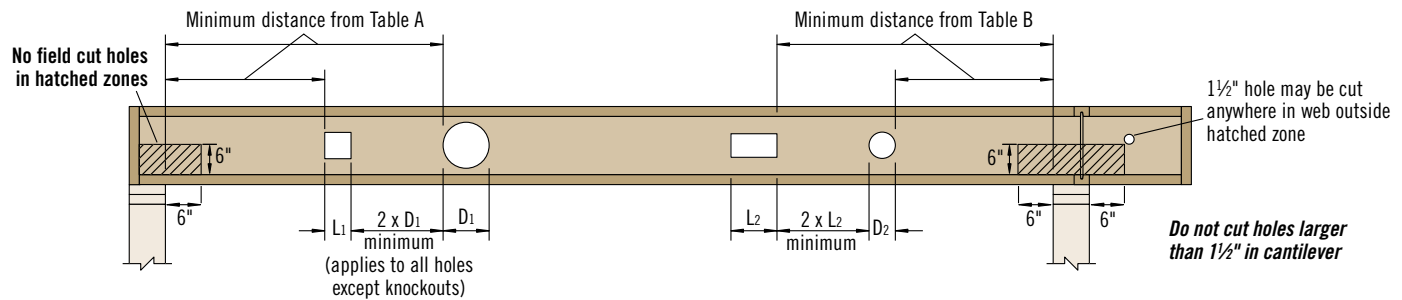

Table A—End Support

Minimum distance from edge of hole to inside face of nearest end support

Depth	TJI®	● Round Hole Size									■ Square or Rectangular Hole Size								
		2"	3"	4"	5"	6 1/2"	7"	8 7/8"	11"	13"	2"	3"	4"	5"	6 1/2"	7"	8 7/8"	11"	13"
9 1/2"	110	1'-0"	1'-6"	2'-0"	2'-6"	5'-0"					1'-0"	1'-6"	2'-6"	3'-6"	4'-6"				
	210	1'-0"	1'-6"	2'-0"	3'-0"	5'-0"					1'-0"	2'-0"	2'-6"	4'-0"	5'-0"				
11 1/8"	110	1'-0"	1'-0"	1'-0"	1'-0"	2'-6"	2'-6"	5'-0"			1'-0"	1'-0"	1'-6"	2'-6"	4'-6"	4'-6"	6'-0"		
	210	1'-0"	1'-0"	1'-0"	1'-6"	2'-6"	3'-0"	5'-6"			1'-0"	1'-0"	2'-0"	3'-0"	5'-0"	5'-6"	6'-6"		
	360	1'-0"	1'-0"	1'-6"	2'-6"	4'-6"	5'-0"	7'-0"			1'-0"	1'-0"	2'-6"	4'-0"	6'-6"	6'-6"	7'-6"		
	560	1'-0"	1'-0"	1'-6"	3'-0"	5'-0"	5'-6"	8'-0"			1'-0"	2'-0"	3'-6"	5'-0"	7'-0"	7'-6"	8'-0"		
14"	110	1'-0"	1'-0"	1'-0"	1'-0"	1'-0"	1'-0"	2'-6"	5'-0"		1'-0"	1'-0"	1'-0"	1'-6"	3'-6"	4'-0"	6'-0"	8'-0"	
	210	1'-0"	1'-0"	1'-0"	1'-0"	1'-0"	1'-0"	3'-0"	6'-0"		1'-0"	1'-0"	1'-0"	2'-0"	4'-0"	4'-6"	6'-6"	8'-6"	
	360	1'-0"	1'-0"	1'-0"	1'-0"	2'-6"	3'-0"	5'-6"	8'-0"		1'-0"	1'-0"	1'-0"	2'-6"	5'-6"	6'-6"	8'-0"	9'-6"	
	560	1'-0"	1'-0"	1'-0"	1'-0"	2'-6"	3'-0"	6'-0"	9'-0"		1'-0"	1'-0"	1'-6"	3'-6"	6'-6"	7'-0"	9'-0"	10'-0"	
16"	210	1'-0"	1'-0"	1'-0"	1'-0"	1'-0"	1'-0"	1'-6"	3'-6"	6'-0"	1'-0"	1'-0"	1'-0"	1'-0"	2'-6"	3'-6"	6'-6"	8'-0"	10'-6"
	360	1'-0"	1'-0"	1'-0"	1'-0"	1'-0"	1'-0"	3'-0"	6'-0"	9'-0"	1'-0"	1'-0"	1'-0"	1'-0"	4'-0"	5'-0"	9'-0"	10'-0"	11'-6"
	560	1'-0"	1'-0"	1'-0"	1'-0"	1'-0"	1'-0"	3'-0"	6'-6"	10'-0"	1'-0"	1'-0"	1'-0"	1'-6"	5'-0"	6'-0"	10'-0"	11'-0"	12'-0"

Table B—Intermediate or Cantilever Support

Minimum distance from edge of hole to inside face of nearest intermediate or cantilever support

Depth	TJI®	● Round Hole Size									■ Square or Rectangular Hole Size								
		2"	3"	4"	5"	6 1/2"	7"	8 7/8"	11"	13"	2"	3"	4"	5"	6 1/2"	7"	8 7/8"	11"	13"
9 1/2"	110	1'-6"	2'-6"	3'-0"	4'-0"	7'-6"					1'-6"	2'-6"	3'-6"	5'-6"	6'-6"				
	210	2'-0"	2'-6"	3'-6"	4'-6"	7'-6"					2'-0"	3'-0"	4'-0"	6'-0"	7'-0"				
11 1/8"	110	1'-0"	1'-0"	1'-6"	2'-6"	4'-0"	4'-0"	8'-0"			1'-0"	1'-6"	2'-6"	4'-0"	6'-6"	7'-0"	9'-0"		
	210	1'-0"	1'-0"	2'-0"	3'-0"	4'-6"	5'-0"	9'-0"			1'-0"	2'-0"	3'-0"	4'-6"	7'-6"	8'-0"	10'-0"		
	360	2'-0"	3'-0"	4'-0"	5'-6"	7'-0"	7'-6"	11'-0"			2'-0"	3'-6"	5'-0"	7'-0"	9'-6"	9'-6"	11'-0"		
	560	1'-6"	3'-0"	4'-6"	5'-6"	8'-0"	8'-6"	12'-0"			3'-0"	4'-6"	6'-0"	8'-0"	10'-6"	11'-0"	12'-0"		
14"	110	1'-0"	1'-0"	1'-0"	1'-0"	2'-0"	2'-6"	4'-6"	8'-0"		1'-0"	1'-0"	1'-0"	2'-6"	5'-0"	6'-0"	9'-0"	12'-0"	
	210	1'-0"	1'-0"	1'-0"	1'-0"	2'-6"	3'-0"	5'-0"	9'-0"		1'-0"	1'-0"	2'-0"	3'-6"	6'-0"	7'-0"	10'-0"	12'-6"	
	360	1'-0"	1'-0"	2'-0"	3'-6"	5'-6"	6'-0"	8'-6"	12'-6"		1'-0"	2'-0"	4'-0"	5'-6"	9'-0"	10'-0"	12'-0"	14'-0"	
	560	1'-0"	1'-0"	1'-6"	3'-6"	5'-6"	6'-6"	9'-6"	13'-6"		1'-0"	3'-0"	5'-0"	7'-0"	10'-0"	11'-0"	13'-6"	15'-0"	
16"	210	1'-0"	1'-0"	1'-0"	1'-0"	1'-0"	1'-0"	3'-0"	5'-6"	9'-6"	1'-0"	1'-0"	1'-0"	2'-0"	4'-6"	5'-6"	9'-6"	12'-6"	15'-6"
	360	1'-0"	1'-0"	1'-0"	1'-0"	3'-0"	4'-0"	6'-6"	10'-0"	13'-6"	1'-0"	1'-0"	1'-0"	2'-0"	4'-0"	7'-6"	8'-6"	13'-0"	17'-0"
	560	1'-0"	1'-0"	1'-0"	1'-0"	2'-6"	3'-6"	7'-0"	11'-0"	15'-0"	1'-0"	1'-0"	3'-6"	5'-6"	9'-0"	10'-0"	14'-6"	16'-0"	18'-0"

Rectangular holes based on measurement of longest side.

How to Use These Tables

- Using **Table A—End Support**, **Table B—Intermediate or Cantilever Support**, or both determine the hole shape/size and select the TJI® joist and depth.
- Scan horizontally until you intersect the correct hole size column.
- Measurement shown is minimum distance from edge of hole to support.
- Place the hole so that the required minimum distance from the end **and** the intermediate or cantilever support is maintained.

General Notes

- Holes may be located vertically anywhere within the web. Leave 1/8" of web (minimum) at top and bottom of hole.
- Knockouts are located in web at approximately 12" on-center; they do not affect hole placement.
- For simple span (5' minimum) uniformly loaded joists meeting the requirements of this guide, one maximum size round hole may be located at the center of the joist span **provided that no other holes occur in the joist**.
- Distances are based on the maximum uniform loads shown in this guide. For other load conditions or hole configurations, use TJ-Beam® software or contact your iLevel representative.

DO NOT
cut or notch flange.



DO NOT
cut holes in cantilever reinforcement.



CANTILEVERS

Cantilevers Less Than 5" (Brick Ledge)

(See Section A of cantilever table on page 13)

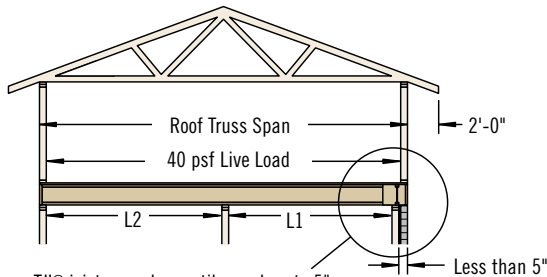

TJI® joists may be cantilevered up to 5" when supporting roof load, assuming

- simple or continuous span
- $L1 \leq L2$
- minimum backspan = 2x cantilever length

Cantilevers 5" to 24"

(See Section B of cantilever table on page 13)

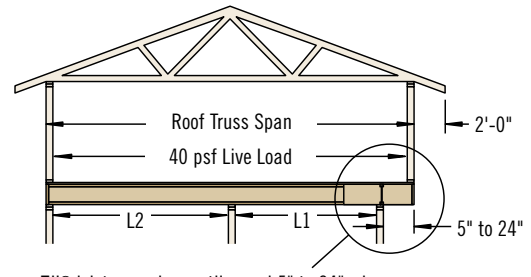

TJI® joists may be cantilevered 5" to 24" when supporting roof load, assuming:

- simple or continuous span
- $L1 \leq L2$
- minimum backspan = 2x cantilever length

TJI® joists are intended for dry-use applications

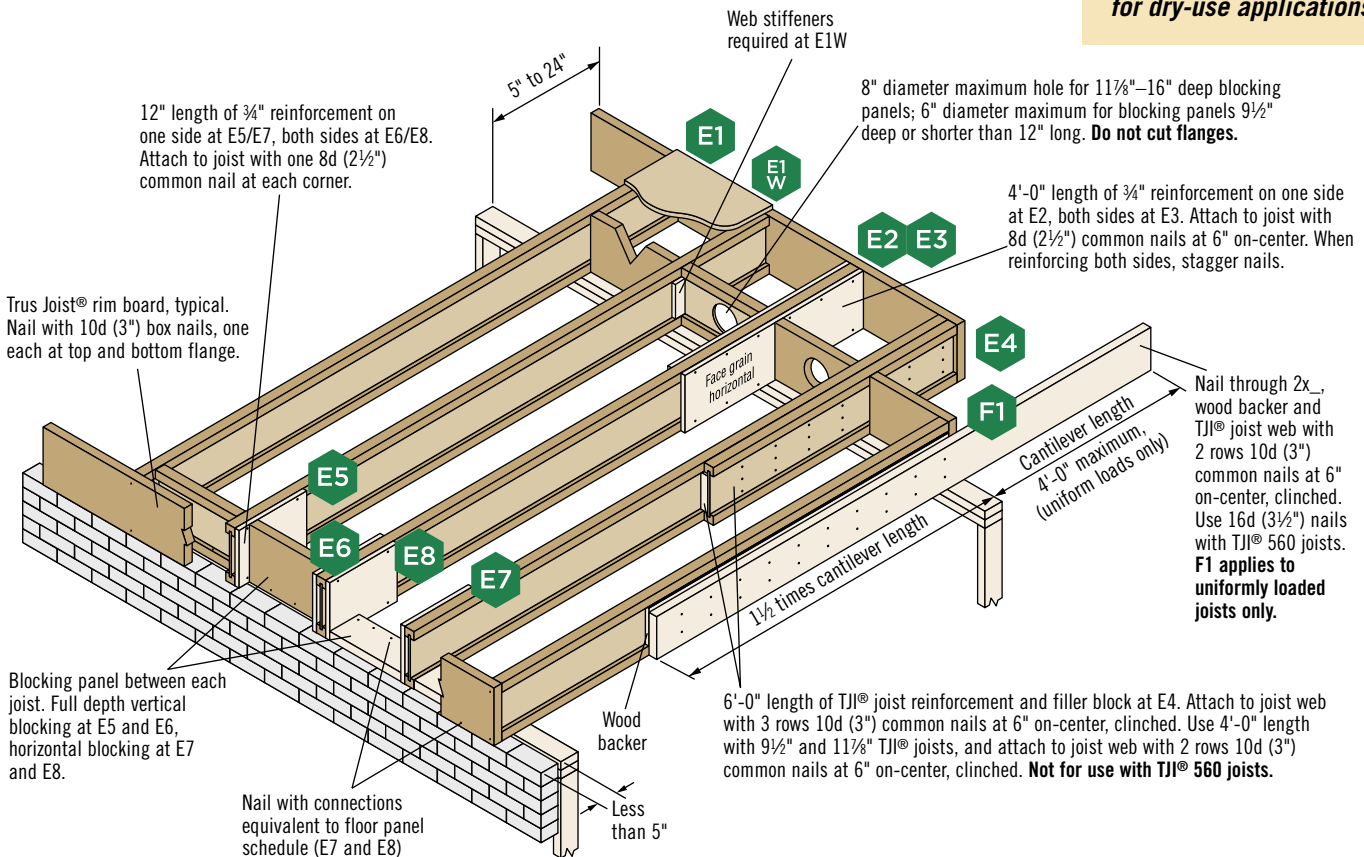

These Conditions Are NOT Permitted

DO NOT bevel cut joist beyond inside face of wall.

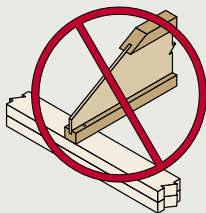

DO NOT use sawn lumber for rim board or blocking.

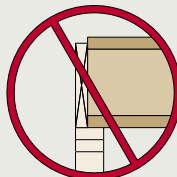

Sawn lumber may shrink after installation.

DO NOT install hanger overhanging face of plate or beam.

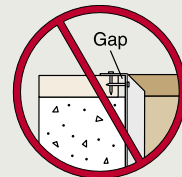

Flush bearing plate with inside face of wall or beam.

Cantilever Reinforcement

Depth	TJI®	Roof Truss Span	Section A: Cantilevers less than 5" (Brick Ledge)									Section B: Cantilevers 5" to 24"								
			Roof Total Load									Roof Total Load								
			35 PSF			45 PSF			55 PSF			35 PSF			45 PSF			55 PSF		
			On-Center Joist Spacing									On-Center Joist Spacing								
16"	19.2"	24"	16"	19.2"	24"	16"	19.2"	24"	16"	19.2"	24"	16"	19.2"	24"	16"	19.2"	24"			
9½" 11⅞" 14"	110	20'			E5		E5	E5		E5	E5				X			X		
		22'			E5		E5	E5	E5	E5	E5				X		X	X		
		24'		E5	E5	E5	E5	E5	E5	E5	E5				X		X	X		
		26'		E5	E5	E5	E5	E5	E5	E5	E6			X		E2	X	E2	X	X
		28'		E5	X	E5	E5	X	E5	E5	X		E2	X	E2	X	X	X	X	X
		30'	E5	E5	X	E5	E5	X	E5	E5	X		E3	X	E3	X	X	X	X	X
32'	E5	X	X	E5	X	X	E5	X	X	E2	X	X	X	X	X	X	X	X		
9½" 11⅞" 14" 16"	210	20'			E5			E5		E5	E5								X	
		22'			E5		E5	E5		E5	E5					E2			X	
		24'			E5		E5	E5	E5	E5	E5					E2			X	
		26'		E5	E5		E5	E5	E5	E5	E5					X		E2	X	
		28'		E5	E5	E5	E5	E5	E5	E5	E6		E2		E2	X	E2	X	X	
		30'		E5	E5	E5	E5	E5	E5	E5	E6			E3	E2	E3	X	E3	X	X
32'	E5	E5	X	E5	E5	X	E5	E5	X		E2	X	E3	X	X	X	X	X		
11⅞" 14" 16"	360	28'			E5		E5	E5	E5	E5									E2	
		30'		E5	E5		E5	E5	E5	E5	E5					E1W			E2	
		32'		E5	E5	E5	E5	E5	E5	E5	E5					E2			E2	
		34'		E5	E5	E5	E5	E5	E5	E5	E6					E2		E1W	E3	
		36'		E5	E5	E5	E5	E5	E5	E5	E6		E1W		E2		E2	E3		
		38'	E5	E5	E5	E5	E5	E5	E5	E5	E6		E1W		E2		E2	E3		
40'	E5	E5	E5	E5	E5	E5	E5	E5	E6		E1W		E1W	E2		E2	E3			
11⅞" 14" 16"	560	30'			E5		E5	E5		E5	E5									
		32'			E5		E5	E5	E5	E5	E5									
		34'			E5		E5	E5	E5	E5	E5							E2		
		36'		E5	E5		E5	E5	E5	E5	E6							E2		
		38'		E5	E5	E5	E5	E5	E5	E5	E6							E2		
		40'		E5	E5	E5	E5	E5	E5	E5	E6				E1W			E2		

How to Use This Table

- Identify TJI® joist and depth.
- Locate the **Roof Truss Span** (horizontal) that meets or exceeds your condition.
- Identify the cantilever condition (less than 5" or 5" to 24") and locate the **Roof Total Load** and **On-Center Joist Spacing** for your application.
- Scan down to find the appropriate cantilever detail and refer to drawing on page 12:
 - Blank cells indicate that no reinforcement is required.
 - E4 may be used in place of E2 or E3 except when using TJI® 560 joists.
 - X indicates that cantilever will not work. Use TJ-Beam® or TJ-Xpert® software, or reduce spacing of joists and recheck table.

General Notes

- Table is based on:
 - 15 psf roof dead load on a horizontal projection.
 - 80 plf exterior wall load with 3'-0" maximum width window or door openings. For larger openings, or multiple 3'-0" width openings spaced less than 6'-0" on-center, additional joists beneath the opening's trimmers may be required.
 - More restrictive of simple or continuous span.
 - Roof truss with 24" soffits.
- ¾" reinforcement refers to ¾" Exposure 1 plywood or other ¾" Exposure 1, 48/24-rated sheathing that is cut to match the full depth of the TJI® joist. Install with face grain horizontal. Reinforcing member must bear fully on the wall plate.
- Designed for 2x4 and 2x6 plate widths.
- For conditions beyond the scope of this table, including cantilevers longer than 24", use our TJ-Beam® or TJ-Xpert® software.

FIRE-SAFE CONSTRUCTION

Fire-safe construction and life safety are major concerns for everyone in the building materials and construction industry. The 2003 statistics on residential fire in the U.S. alone include 3,145 fire fatalities and \$6.1 billion in property damage. These numbers underscore the seriousness of the issue and the need for fire-safe construction.

Over the past 30 years, prefabricated wood I-joists have established a record of safe and reliable performance in millions of structures. Many of these structures, such as one- or two-family residential dwellings, do not require specific fire-endurance ratings per the building codes. The following information is intended to help you specify and install iLevel™ products with fire safety in mind.

Active Fire Suppression

iLevel supports the position that homeowners, firefighters, insurers, and the community at large benefit from the use of properly installed fire sprinkler systems. Automatic residential fire sprinkler systems have an excellent record of performance and offer the best available protection to occupants and their property. Today's modern systems are inconspicuous and efficient, and can be installed for less cost than the typical homeowner will spend to carpet their floors. This type of fire suppression system will:

- provide early and unsupervised fire suppression
- reduce smoke development
- enhance life safety
- reduce potential for significant property damage

Smoke Detectors

Smoke detectors are universally recognized as the most cost-effective life-saving devices. While smoke detectors do not provide protection to the structure or to the contents in a home, they do alert occupants to potential fire hazards and allow them time to escape.

Passive Fire Protection

Independent tests have proven that unprotected, lightweight framing systems—whether combustible or non-combustible—suffer serious and rapid structural degradation when exposed to heat and fire. All floor framing materials—sawn lumber, wood I-joists, trusses, and light gauge steel—succumb quickly to fire if not protected. In fire scenarios, a protective membrane such as gypsum ceiling board will provide additional protection to the structural framing members. Passive fire-suppression methods will:

- delay fire growth
- reduce potential for significant property damage
- enhance the market value of the home

Suggested Minimum Membrane Construction

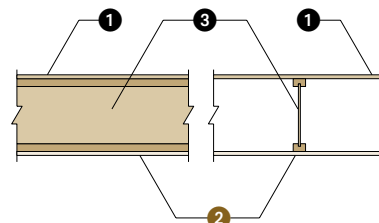

iLevel supports the idea that all floor/ceiling and roof/ceiling assemblies in habitable areas be protected by a minimum membrane protection consisting of 1/2" gypsum board (or equivalent)

- ❶ 48/24 tongue-and-groove, span-rated floor panels (Exposure 1)
- ❷ Single layer of 1/2" thick gypsum board
- ❸ TJI® joists

One-Hour Rated Assembly

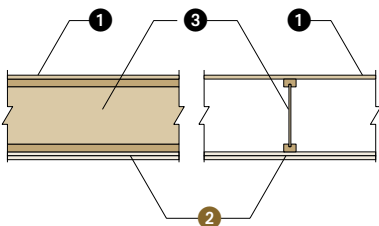

- ❶ 48/24 tongue-and-groove, span-rated floor panels (Exposure 1)
- ❷ Two layers of 1/2" thick Type X gypsum board
- ❸ TJI® joists

For more information on fire assemblies and fire-safe construction, please refer to the iLevel Fire Facts Guide (Reorder #5003) or visit www.iLevel.com and www.i-joist.com

Note:

- Resilient channels (not shown) may be installed between the joists and gypsum board if improved STC and IIC sound ratings are desired.
- Resilient channels are required when optional 3/2" thick glass fiber batt insulation is being installed.

Reference: ICC ES ESR-1153



Silent Floor® joists are structurally uniform and dimensionally stable, and they resist shrinking and twisting. This helps prevent gaps from forming around the nails between the joist and the floor panels—gaps that can potentially cause squeaks or other floor noise.

Using Silent Floor® joists can help you build a quieter floor, but only if the entire floor system is installed properly. This is because other components of the floor system, such as hangers, connectors, and nails can be a source of floor noise.

To get the best possible performance out of your Silent Floor® joists and minimize potential squeaks in your floor, we recommend the following installation tips:

Properly Seat Each Joist in Hanger

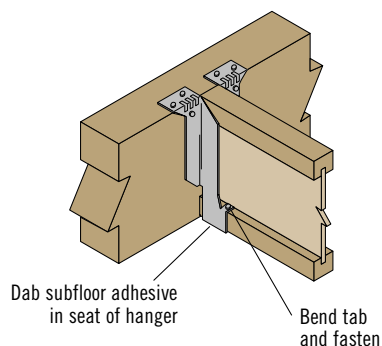

Seat the joist tight to the bottom of the hanger. When using hangers with tabs, bend the flange tabs over and nail to the TJI® joist bottom flange.

Placing a dab of subfloor adhesive in the seat of the hanger prior to installing the joist can reduce squeaks.

Use Adhesive and Special Nailing When Needed

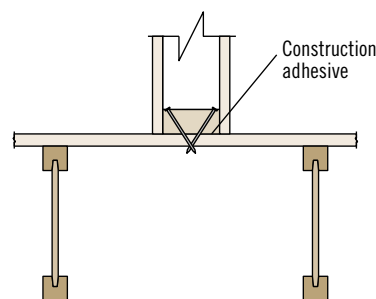

Nail interior partitions to the joists when possible. If the wall can only be nailed to the floor panel, run a bead of adhesive under the wall and either cross nail, nail through and clinch tight, or screw into the wall from below.

Prevent Shrinkage

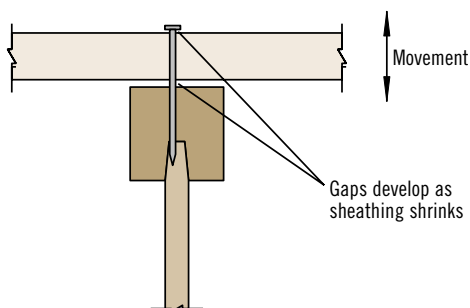

Keep building materials dry, and properly glue floor panels to the joists. Panels that become excessively wet during construction shrink as they dry. This shrinkage may leave gaps that allow the panel to move when stepped on.

Avoid “Shiners”

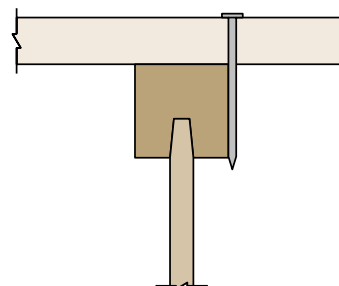

Exercise care when nailing. Nails that barely hit the joists (shiners) do not hold the panel tight to the joist and should be removed. If left in, the nails will rub against the side of the joist when the panel deflects.

For more information and tips on how to prevent floor noise, refer to the Field Guide for Prevention and Repair of Squeaks (Reorder #2065) or contact your iLevel representative.

ROOF SPAN TABLE

Maximum Horizontal Clear Spans—Roof

O.C. Spacing	Depth	TJI®	Design Live Load (LL) and Dead Load (DL) in PSF											
			Non-Snow (125%)				Snow Load Area (115%)							
			20LL + 15DL		20LL + 20DL		25LL + 15DL		30LL + 15DL		40LL + 15DL		50LL + 15DL	
			Low	High	Low	High	Low	High	Low	High	Low	High	Low	High
16"	9½"	110	19'-3"	17'-2"	18'-4"	16'-3"	18'-5"	16'-6"	17'-9"	15'-11"	16'-7"	15'-0"	15'-6"	14'-3"
		210	20'-5"	18'-2"	19'-5"	17'-3"	19'-6"	17'-6"	18'-9"	16'-11"	17'-7"	15'-11"	16'-7"	15'-1"
	11⅞"	110	23'-0"	20'-6"	21'-11"	19'-5"	22'-0"	19'-9"	20'-11"	19'-1"	19'-0"	17'-11"	17'-6"	16'-11"
		210	24'-4"	21'-9"	23'-3"	20'-7"	23'-4"	20'-11"	22'-5"	20'-2"	20'-10"	19'-0"	19'-2"	18'-0"
		360	27'-9"	24'-9"	26'-5"	23'-5"	26'-7"	23'-10"	25'-6"	23'-0"	23'-11"	21'-7"	22'-7"	20'-6"
		560	31'-11"	28'-6"	30'-5"	27'-0"	30'-7"	27'-5"	29'-5"	26'-5"	27'-6"	24'-10"	26'-0"	23'-7"
	14"	110	26'-3"	23'-5"	25'-0"	22'-2"	24'-1"	22'-6"	22'-9"	21'-9"	20'-8"	19'-11"	19'-1"	18'-5"
		210	27'-9"	24'-9"	26'-5"	23'-5"	26'-5"	23'-9"	25'-0"	22'-11"	22'-8"	21'-7"	20'-11"	20'-3"
		360	31'-6"	28'-2"	30'-0"	26'-8"	30'-2"	27'-1"	29'-0"	26'-1"	27'-2"	24'-7"	25'-8"	23'-4"
		560	36'-3"	32'-4"	34'-6"	30'-7"	34'-8"	31'-1"	33'-4"	30'-0"	31'-2"	28'-3"	29'-6"	26'-9"
	16"	210	30'-9"	27'-9"	29'-4"	26'-0"	28'-3"	26'-5"	26'-9"	25'-6"	24'-3"	23'-4"	22'-4"	21'-8"
		360	34'-11"	31'-2"	33'-3"	29'-6"	33'-5"	30'-0"	32'-2"	28'-11"	30'-1"	27'-2"	26'-0"	25'-10"
		560	40'-1"	35'-9"	38'-2"	33'-11"	38'-4"	34'-5"	36'-11"	33'-2"	34'-6"	31'-3"	31'-8"	29'-8"
	19.2"	110	18'-1"	16'-1"	17'-3"	15'-3"	17'-4"	15'-6"	16'-8"	15'-0"	15'-5"	14'-11"	14'-2"	13'-4"
		210	19'-2"	17'-1"	18'-3"	16'-2"	18'-4"	16'-5"	17'-8"	15'-10"	16'-6"	14'-11"	15'-7"	14'-2"
		110	21'-7"	19'-3"	20'-7"	18'-3"	20'-3"	18'-6"	19'-1"	17'-11"	17'-4"	16'-8"	16'-0"	15'-5"
		210	22'-11"	20'-5"	21'-10"	19'-4"	21'-11"	19'-8"	20'-11"	18'-11"	19'-0"	17'-10"	17'-6"	16'-11"
		360	26'-1"	23'-3"	24'-10"	22'-0"	24'-11"	22'-4"	24'-0"	21'-7"	22'-5"	20'-3"	21'-2"	19'-3"
		560	30'-0"	26'-9"	28'-7"	25'-4"	28'-8"	25'-9"	27'-7"	24'-10"	25'-9"	23'-4"	24'-4"	22'-2"
		110	24'-6"	22'-0"	22'-10"	20'-10"	22'-0"	20'-11"	20'-9"	18'-10"	18'-10"	17'-2"	17'-4"	16'-10"
		210	26'-0"	23'-3"	24'-10"	22'-0"	24'-2"	22'-4"	22'-10"	21'-7"	20'-8"	19'-11"	18'-10"	18'-5"
		360	29'-7"	26'-5"	28'-2"	25'-0"	28'-4"	25'-5"	27'-3"	24'-6"	25'-6"	23'-1"	21'-7"	21'-8"
		560	34'-0"	30'-4"	32'-5"	28'-9"	32'-7"	29'-2"	31'-4"	28'-2"	29'-3"	26'-6"	26'-5"	25'-2"
		210	28'-8"	25'-9"	26'-9"	24'-5"	25'-10"	24'-6"	24'-5"	23'-4"	22'-1"	21'-4"	18'-10"	19'-8"
		360	32'-10"	29'-3"	31'-3"	27'-9"	31'-5"	28'-2"	30'-2"	27'-2"	25'-7"	25'-3"	21'-7"	21'-8"
		560	37'-8"	33'-7"	35'-10"	31'-10"	36'-0"	32'-4"	34'-8"	31'-2"	31'-3"	29'-4"	26'-5"	25'-5"
24"	9½"	110	16'-9"	14'-11"	15'-11"	14'-2"	16'-0"	14'-4"	15'-2"	13'-10"	13'-9"	13'-0"	12'-8"	12'-3"
		210	17'-9"	15'-10"	16'-11"	15'-0"	17'-0"	15'-3"	16'-4"	14'-8"	15'-1"	13'-10"	13'-11"	13'-1"
	11⅞"	110	20'-0"	17'-10"	18'-9"	16'-11"	18'-1"	17'-2"	17'-1"	16'-4"	15'-6"	14'-11"	13'-7"	13'-10"
		210	21'-2"	18'-11"	20'-2"	17'-11"	19'-10"	18'-2"	18'-9"	17'-7"	17'-0"	16'-4"	15'-0"	15'-2"
		360	24'-1"	21'-6"	23'-0"	20'-5"	23'-1"	20'-8"	22'-2"	20'-0"	20'-5"	18'-9"	17'-3"	17'-4"
		560	27'-9"	24'-9"	26'-5"	23'-6"	26'-7"	23'-10"	25'-6"	23'-0"	23'-10"	21'-7"	21'-1"	20'-3"
	14"	110	21'-10"	20'-4"	20'-4"	19'-1"	19'-8"	18'-8"	18'-7"	17'-9"	16'-0"	16'-3"	13'-7"	14'-2"
		210	24'-0"	21'-6"	22'-4"	20'-5"	21'-7"	20'-6"	20'-4"	19'-6"	17'-10"	17'-9"	15'-0"	15'-8"
		360	27'-5"	24'-6"	26'-1"	23'-2"	26'-3"	23'-6"	25'-0"	22'-8"	20'-5"	20'-2"	17'-3"	17'-4"
		560	31'-6"	28'-1"	30'-0"	26'-8"	30'-2"	27'-0"	29'-0"	26'-1"	24'-11"	23'-7"	21'-1"	20'-3"
	16"	210	25'-8"	23'-11"	23'-11"	22'-4"	23'-1"	21'-11"	21'-9"	20'-10"	17'-10"	18'-3"	15'-0"	15'-8"
		360	30'-4"	27'-1"	28'-11"	25'-8"	28'-2"	26'-1"	25'-0"	24'-1"	20'-5"	20'-2"	17'-3"	17'-4"
		560	34'-10"	31'-2"	33'-2"	29'-6"	33'-4"	29'-11"	30'-6"	28'-3"	24'-11"	23'-7"	21'-1"	20'-3"

See page 17 for General Notes and information on how to use this table

How to Use Roof Span Table on page 16

1. Determine appropriate live and dead load, and the load duration factor.
2. If your slope is 6/12 or less use the **Low** slope column. If it is between 6/12 and 12/12 use the **High** column.
3. Scan down the column until you find a span that meets or exceeds the span of your application.
4. Select TJI® joist and on-center spacing.

General Notes

- Table is based on:
 - Uniform loads.
 - More restrictive of simple or continuous span.
 - Minimum roof surface slope of ¼" in 12".
 - 1¾" minimum end bearing and 3½" minimum intermediate bearing.
- Total load limits joist deflection to L/180.
- Live load is based on joist deflection of L/240.
- A support beam or wall at the high end is required (ridge board applications do not provide adequate support).
- Spans shown assume no web stiffeners at intermediate bearings.

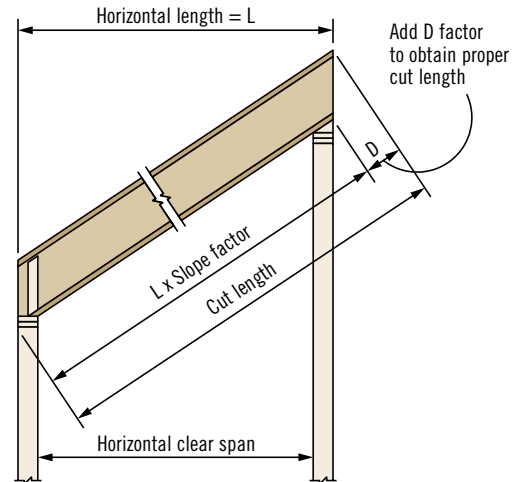

Actual cut length can be approximated by multiplying the horizontal length by the slope factor and adding the D factor.

D Factors

Depth	Slope												
	2½ in 12	3 in 12	3½ in 12	4 in 12	4½ in 12	5 in 12	6 in 12	7 in 12	8 in 12	9 in 12	10 in 12	11 in 12	12 in 12
9½"	2"	2⅜"	2⅞"	3¼"	3⅝"	4"	4¾"	5⅝"	6⅜"	7⅞"	8"	8¾"	9½"
11⅞"	2½"	3"	3½"	4"	4½"	5"	6"	7"	8"	9"	10"	11"	11⅞"
14"	3"	3½"	4⅛"	4¾"	5¼"	5⅞"	7"	8¼"	9⅝"	10½"	11¾"	12⅞"	14"
16"	3⅜"	4"	4¾"	5⅝"	6"	6¾"	8"	9⅝"	10¾"	12"	13⅝"	14¾"	16"

Slope Factors

Slope	2½ in 12	3 in 12	3½ in 12	4 in 12	4½ in 12	5 in 12	6 in 12	7 in 12	8 in 12	9 in 12	10 in 12	11 in 12	12 in 12
Factor	1.021	1.031	1.042	1.054	1.068	1.083	1.118	1.158	1.202	1.250	1.302	1.357	1.414



WARNING
Joists are unstable until laterally braced.
See Warning Notes on page 5.

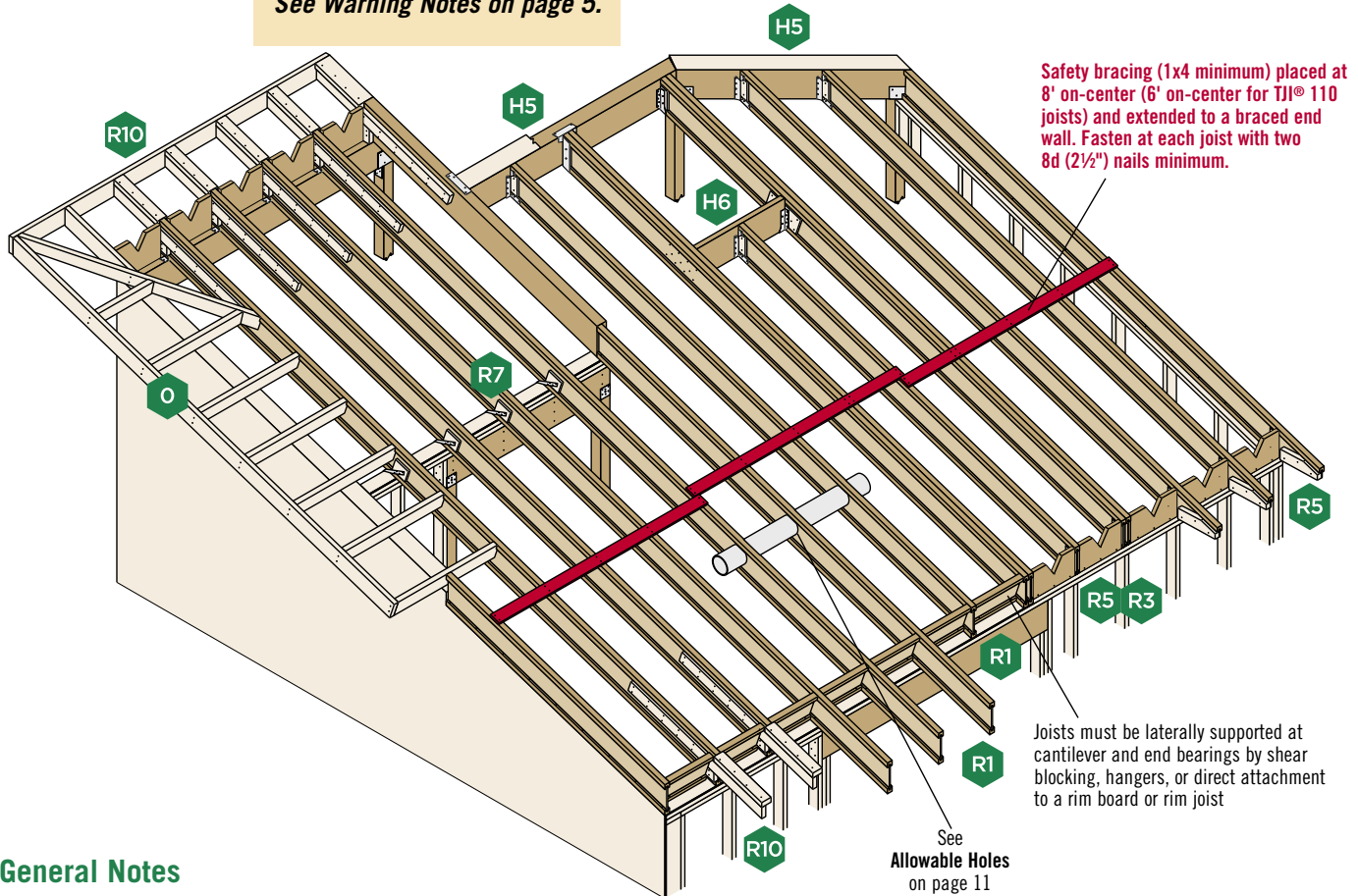

General Notes

- Unless otherwise noted, all details are valid to a maximum slope of 12/12.
- Web stiffeners are required if the sides of the hanger do not laterally support at least ⅜" of the TJI® joist top flange.

TJI® Joist Nailing Requirements at Bearing

TJI® Joist to Bearing Plate

End Bearing (1¾" minimum bearing required)

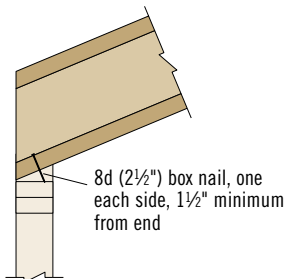

Intermediate Bearing (3½" minimum bearing required)

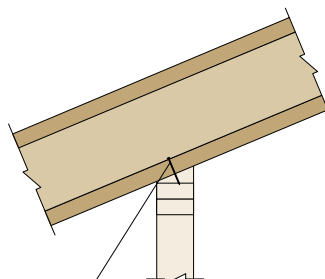

Blocking to Bearing Plate

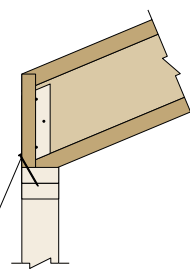

Shear transfer nailing:
Use connections equivalent to sheathing nail schedule

When slope exceeds ¼" per foot, a beveled bearing plate, variable slope seat connector, or birdsmouth cut (at low end of joist only) is required

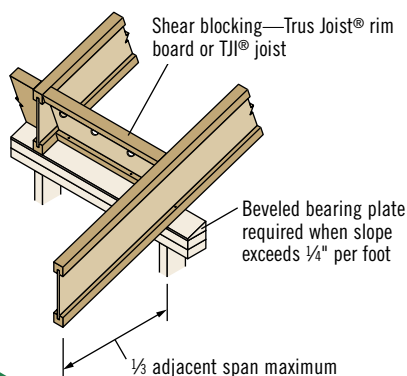

R1

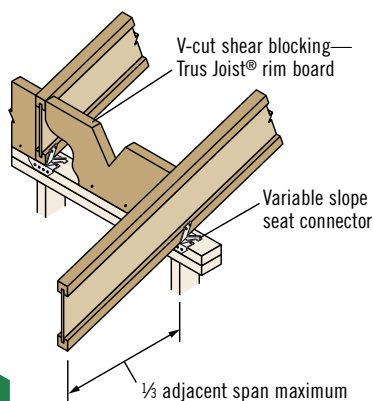

R3

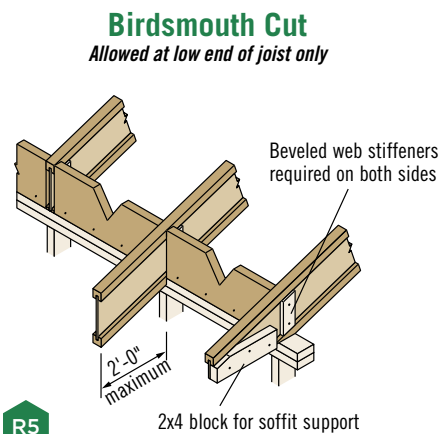

R5

Intermediate Bearing

Blocking panels or shear blocking are optional for joist stability at intermediate supports

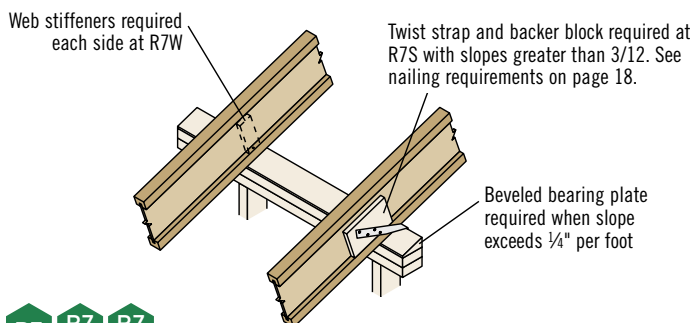

R7

R7W

R7S

Birdsmouth Cut

Allowed at low end of joist only

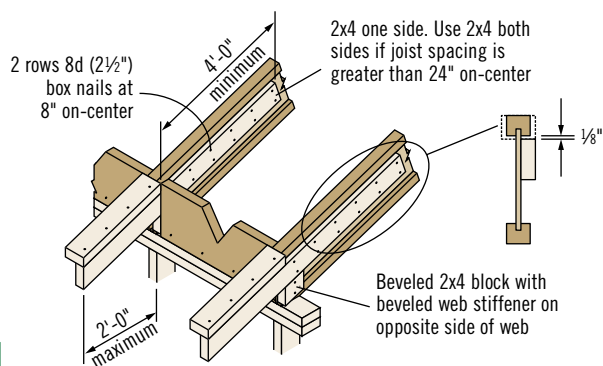

R8

Birdsmouth Cut

Allowed at low end of joist only

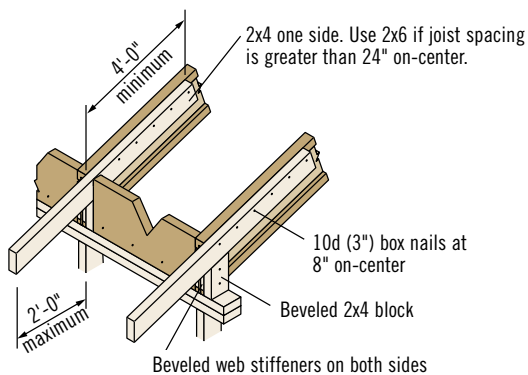

R9

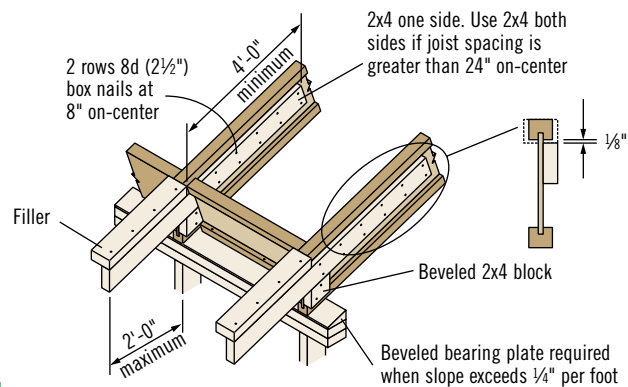

R10

These Conditions Are NOT Permitted

DO NOT cut holes too close to support.

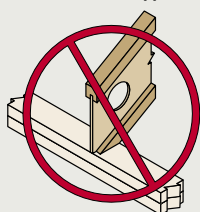

Refer to Allowable Holes on page 11 for minimum distance from support.

DO NOT bevel cut joist beyond inside face of wall.

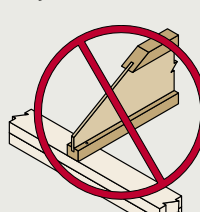

DO NOT overhang birdsmouth cut from inside face of plate.

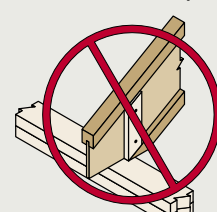

TJI® joist flange must bear fully on the plate. See detail BC on page 20.

ROOF DETAILS

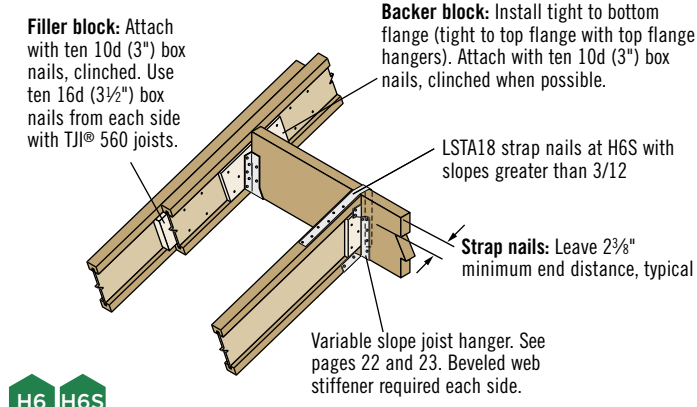
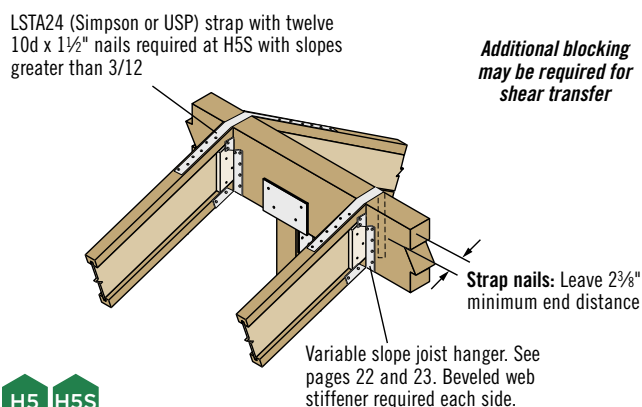
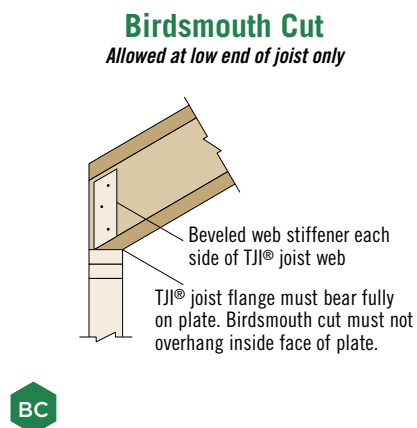
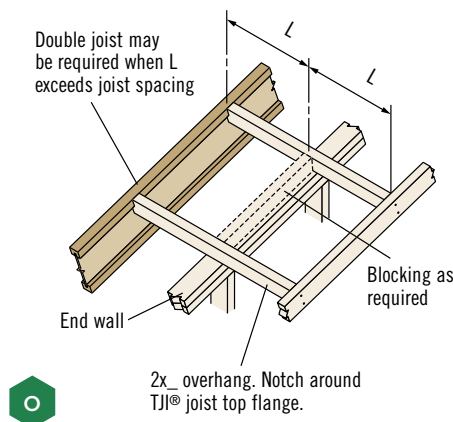
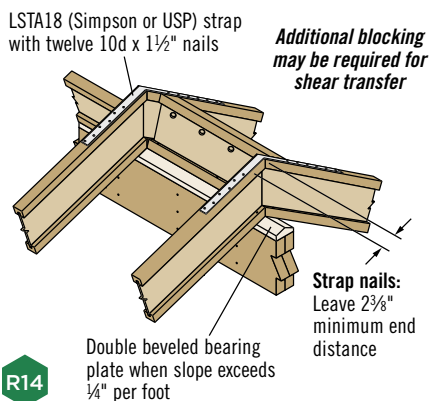

Shear Blocking and Ventilation Holes (Roof Only)

Field trim to match joist depth at outer edge of wall or locate on wall to match joist depth

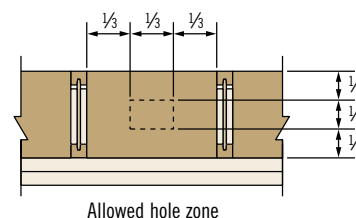
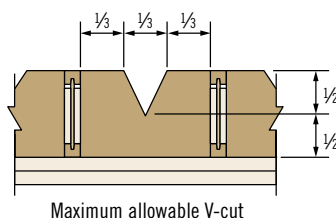
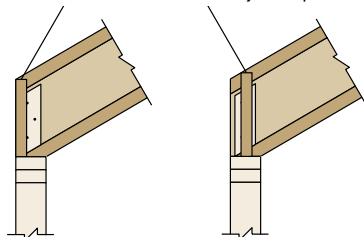

SB For TJI® joists with slopes of 10/12 to 12/12, the vertical depth at bearing will require Trus Joist® rim board (for shear blocking) that is one size deeper than the TJI® joist

Filler and Backer Block Sizes

TJI®	110		210		360		560	
Depth	9½" or 11⅞"	14"	9½" or 11⅞"	14" or 16"	9½" or 11⅞"	14" or 16"	11⅞"	14" or 16"
Filler Block (Detail H6)	2x6	2x8	2x6 + ⅜" sheathing	2x8 + ⅜" sheathing	2x6 + ½" sheathing	2x8 + ½" sheathing	Two 2x6	Two 2x8
Backer Block (Detail H6)	⅝" or ¾"		¾" or ⅞"		1" net		2x6	2x8

If necessary, increase filler and backer block height for face mount hangers and maintain ⅛" gap at top of joist. See detail W. Filler and backer block dimensions should accommodate required nailing without splitting. The suggested minimum length is 24" for filler and 12" for backer blocks.

See General Notes and nailing requirements on page 18

Roof—115% and 125% Load Duration (PLF)

Depth	TJI®	Roof Joist Horizontal Clear Span																	
		6'			8'			10'			12'			14'			16'		
		Total Load		Defl.	Total Load		Defl.	Total Load		Defl.	Total Load		Defl.	Total Load		Defl.	Total Load		Defl.
		Snow 115%	Non-Snow 125%	Live Load L/240	Snow 115%	Non-Snow 125%	Live Load L/240	Snow 115%	Non-Snow 125%	Live Load L/240	Snow 115%	Non-Snow 125%	Live Load L/240	Snow 115%	Non-Snow 125%	Live Load L/240	Snow 115%	Non-Snow 125%	Live Load L/240
9½"	110	289	314	*	218	237	*	175	190	*	146	159	155	109	118	101	83	91	69
	210	321	349	*	242	263	*	194	211	*	162	176	*	131	142	118	100	108	81
11⅞"	110	289	314	*	218	237	*	175	190	*	146	159	*	125	136	*	106	115	*
	210	321	349	*	242	263	*	194	211	*	162	176	*	139	151	*	122	132	*
	360	368	400	*	277	301	*	223	242	*	186	202	*	159	173	*	140	152	*
	560	449	488	*	338	368	*	272	295	*	227	246	*	195	212	*	170	185	*
14"	110	289	314	*	218	237	*	175	190	*	146	159	*	125	136	*	110	119	*
	210	321	349	*	242	263	*	194	211	*	162	176	*	139	151	*	122	132	*
	360	368	400	*	277	301	*	223	242	*	186	202	*	159	173	*	140	152	*
	560	449	488	*	338	368	*	272	295	*	227	246	*	195	212	*	170	185	*
16"	210	321	349	*	242	263	*	194	211	*	162	176	*	139	151	*	122	132	*
	360	368	400	*	277	301	*	223	242	*	186	202	*	159	173	*	140	152	*
	560	449	488	*	338	368	*	272	295	*	227	246	*	195	212	*	170	185	*

Depth	TJI®	Roof Joist Horizontal Clear Span																	
		18'			20'			22'			24'			26'			28'		
		Total Load		Defl.	Total Load		Defl.	Total Load		Defl.	Total Load		Defl.	Total Load		Defl.	Total Load		Defl.
		Snow 115%	Non-Snow 125%	Live Load L/240	Snow 115%	Non-Snow 125%	Live Load L/240	Snow 115%	Non-Snow 125%	Live Load L/240	Snow 115%	Non-Snow 125%	Live Load L/240	Snow 115%	Non-Snow 125%	Live Load L/240	Snow 115%	Non-Snow 125%	Live Load L/240
9½"	110																		
	210	77	77	58															
11⅞"	110	84	91	82															
	210	101	109	96	82	89	71												
	360	124	135	*	112	122	103	102	105	78	82	82	61						
	560	152	165	*	137	148	*	124	135	117	114	122	91	97	97	73	79	79	59
14"	110	98	106	*	80	87	*												
	210	108	118	*	97	105	103	80	87	79									
	360	124	135	*	112	122	*	102	111	*	93	101	88	86	94	70	76	76	57
	560	152	165	*	137	148	*	124	135	*	114	124	*	105	114	104	98	106	85
16"	210	108	118	*	97	106	*	89	96	*	77	83	*						
	360	124	135	*	112	122	*	102	111	*	93	101	*	86	94	*	80	87	76
	560	152	165	*	137	148	*	124	135	*	114	124	*	105	114	*	98	106	*

* Indicates **TOTAL LOAD** value controls.

Slope Factors

Slope Factor	2½ in 12	3 in 12	3½ in 12	4 in 12	4½ in 12	5 in 12	6 in 12	7 in 12	8 in 12	9 in 12	10 in 12	11 in 12	12 in 12
	1.021	1.031	1.042	1.054	1.068	1.083	1.118	1.158	1.202	1.250	1.302	1.357	1.414



How to Use These Tables



- Calculate actual total load in pounds per linear foot (plf).
- Select appropriate **Roof Joist Horizontal Clear Span**. For slopes greater than 2" per foot, approximate the increased dead load by multiplying the joist horizontal clear span by the **Slope Factor** above.
- Scan down the column to find a TJI® joist that meets or exceeds actual total load. **Total Load** values are limited to deflection of L/180. For stiffer deflection criteria, use the **Live Load** L/240 values.

General Notes

- Tables are based on:
 - Uniform loads.
 - No composite action provided by sheathing.
 - More restrictive of simple or continuous span.
 - Minimum roof surface slope of ¼" in 12".
- Total Load** limits joist deflection to L/180.

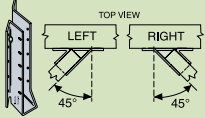
FRAMING CONNECTORS (SIMPSON STRONG-TIE™)

Joist		Single Joist—Top Flange					Single Joist—Face Mount ⁽¹⁾					Face Mount Skewed 45° Joist Hanger ⁽¹⁾				
																
Depth	TJI®	Hanger	Capacity (lbs)	Nailing		Hanger	Capacity (lbs)	Nailing		Hanger	Capacity (lbs)	Nailing		Hanger	Capacity (lbs)	Nailing
				Header	Joist			Header	Joist			Header	Joist			
9½"	110	ITT9.5	935	10d	10d x 1½"	IUS1.81/9.5	935	10d	N.A.	SUR/L1.81/9	1,125	16d	10d x 1½"			
	210	ITT2.1/9.5	1,030	10d	10d x 1½"	IUS2.06/9.5	935	10d	N.A.	SUR/L2.1/9	1,230	16d	10d x 1½"			
11⅞"	110	ITT11.88	950	10d	10d x 1½"	IUS1.81/11.88	950	10d	N.A.	SUR/L1.81/11	1,215	16d	10d x 1½"			
	210	ITT2.1/11.88	1,045	10d	10d x 1½"	IUS2.06/11.88	1,045	10d	N.A.	SUR/L2.1/11	1,305	16d	10d x 1½"			
	360	ITT3511.88	1,140	10d	10d x 1½"	IUS2.37/11.88	1,140	10d	N.A.	SURI/LI3510/12	1,355	16d	10d x 1½"			
	560	ITT411.88	1,300	10d	10d x 1½"	IUS3.56/11.88	1,330	10d	N.A.	SUR/L410	1,495	16d	10d x 1½"			
14"	110	ITT14	950	10d	10d x 1½"	IUS1.81/14	950	10d	N.A.	SUR/L1.81/11	1,215	16d	10d x 1½"			
	210	ITT2.1/14	1,045	10d	10d x 1½"	IUS2.06/14	1,045	10d	N.A.	SUR/L2.1/11	1,305	16d	10d x 1½"			
	360	ITT3514	1,140	10d	10d x 1½"	IUS2.37/14	1,140	10d	N.A.	SURI/LI3514/20	1,355	16d	10d x 1½"			
	560	ITT414	1,300	10d	10d x 1½"	IUS3.56/14	1,330	10d	N.A.	SUR/L414	1,460	16d	10d x 1½"			
16"	210	ITT2.1/16	1,045	10d	10d x 1½"	IUS2.06/16	1,045	10d	N.A.	SUR/L2.1/11	1,045	16d	10d x 1½"			
	360	MIT3516	1,260	10d	10d x 1½"	IUS2.37/16	1,140	10d	N.A.	SURI/LI3514/20	1,355	16d	10d x 1½"			
	560	MIT416	1,460	10d	10d x 1½"	IUS3.56/16	1,330	10d	N.A.	SUR/L414	1,460	16d	10d x 1½"			

Joist		Double Joist—Top Flange					Double Joist—Face Mount ⁽¹⁾				
											
Depth	TJI®	Hanger	Capacity (lbs)	Nailing		Hanger	Capacity (lbs)	Nailing		Hanger	Capacity (lbs)
				Header	Joist			Header	Joist		
9½"	110	MIT49.5	2,000	16d	10d x 1½"	MIU49	1,860	16d	10d x 1½"		
	210	MIT4.28/9.5	2,000	16d	10d x 1½"	MIU4.28/9	1,860	16d	10d x 1½"		
11⅞"	110	MIT411.88	2,000	16d	10d x 1½"	MIU411	2,130	16d	10d x 1½"		
	210	MIT4.28/11.88	2,000	16d	10d x 1½"	MIU4.28/11	2,130	16d	10d x 1½"		
	360	MIT3511.88-2	2,000	16d	10d x 1½"	MIU4.75/11	2,130	16d	10d x 1½"		
	560	WPI411.88-2	2,925	16d	10d x 1½"	HU412-2	2,145	16d	10d x 1½"		
14"	110	MIT414	2,000	16d	10d x 1½"	MIU414	2,170	16d	10d x 1½"		
	210	MIT4.28/14	2,000	16d	10d x 1½"	MIU4.28/14	2,350	16d	10d x 1½"		
	360	MIT3514-2	2,000	16d	10d x 1½"	MIU4.75/14	2,395	16d	10d x 1½"		
	560	WPI414-2	2,925	16d	10d x 1½"	HU414-2	2,680	16d	10d x 1½"		
16"	210	LBV4.28/16	2,035	16d	10d x 1½"	MIU4.28/16	2,350	16d	10d x 1½"		
	360	LBV3516-2	2,035	16d	10d x 1½"	MIU4.75/16	2,525	16d	10d x 1½"		
	560	WPI416-2	2,925	16d	10d x 1½"	HU414-2	2,680	16d	10d x 1½"		

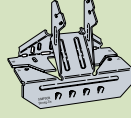
Joist		Variable Slope Seat Connector ⁽²⁾				
						
TJI®	Hanger	Capacity (lbs)	Nailing		Hanger	Capacity (lbs)
			Header	Joist		
110	VPA25	1,050	10d	10d x 1½"		
210	VPA2.1	1,230	10d	10d x 1½"		
360	VPA35	1,230	10d	10d x 1½"		
560	VPA4	1,230	10d	10d x 1½"		

Hanger information on these two pages was provided by either Simpson Strong-Tie™ or USP Structural Connectors™. For additional information, please refer to their literature.

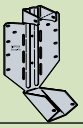
Joist		Variable Slope Seat Joist Hanger ⁽¹⁾⁽³⁾				
						
TJI®	Hanger	Capacity (lbs)		Nailing		Hanger
		Sloped Only	Sloped and Skewed	Header	Joist	
110	LSSU125	1,110	995	10d	10d x 1½"	
210	LSSU2.1	1,110	995	10d	10d x 1½"	
360	LSSU135	1,110	995	10d	10d x 1½"	
560	LSSU410	1,725	1,625	16d	10d x 1½"	

General Notes

Bold italic hangers require web stiffeners.

Capacities will vary with different nailing criteria or other support conditions; contact your iLevel representative for assistance.

- Hanger capacities shown are either joist bearing capacity or hanger capacity—whichever is less. Joist end reaction must be checked to ensure it does not exceed the capacity shown in the tables.
- All capacities are for downward loads at 100% duration of load.
- Fill all round, dimple, and positive angle nail holes.
- Use sloped seat hangers and beveled web stiffeners when TJI® joist slope exceeds ¼" per foot.
- Leave ⅛" clearance (⅜" maximum) between the end of the supported joist and the header or hanger.

See additional notes on page 23

FRAMING CONNECTORS (USP STRUCTURAL CONNECTORS™)

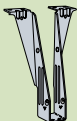
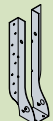
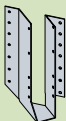
Joist		Single Joist—Top Flange				Single Joist—Face Mount ⁽¹⁾				Face Mount Skewed 45° Joist Hanger ⁽¹⁾⁽⁴⁾			
													
Depth	TJI®	Hanger	Capacity (lbs)	Nailing		Hanger	Capacity (lbs)	Nailing		Hanger	Capacity (lbs)	Nailing	
				Header	Joist			Header	Joist			Header	Joist
9½"	110	TH017950	935	10d	10d x 1½"	THF17925	895	10d	10d x 1½"	SKH1720L/R	910	10d	10d x 1½"
	210	TH020950	1,030	10d	10d x 1½"	THF20925	895	10d	10d x 1½"	SKH2020L/R	1,005	10d	10d x 1½"
11⅞"	110	TH017118	950	10d	10d x 1½"	THF17112	895	10d	10d x 1½"	SKH1720L/R	920	10d	10d x 1½"
	210	TH020118	1,030	10d	10d x 1½"	THF20112	895	10d	10d x 1½"	SKH2020L/R	1,015	10d	10d x 1½"
	360	TH023118	1,230	10d	10d x 1½"	THF23118	1,260	10d	10d x 1½"	SKH2320L/R	1,110	10d	10d x 1½"
	560	TH035118	1,430	10d	10d x 1½"	THF17112-2	1,460	10d	10d	SKH410L/R1	1,460	16d	16d
14"	110	TH017140	1,215	10d	10d x 1½"	THF17140	950	10d	10d x 1½"	SKH1720L/R	920	10d	10d x 1½"
	210	TH020140	1,080	10d	10d x 1½"	THF20140	1,045	10d	10d x 1½"	SKH2020L/R	1,015	10d	10d x 1½"
	360	TH023140	1,230	10d	10d x 1½"	THF23140	1,260	10d	10d x 1½"	SKH2324L/R	1,110	10d	10d x 1½"
	560	TH035140	1,430	10d	10d x 1½"	THF17140-2	1,460	10d	10d	SKH414L/R1	1,460	16d	16d
16"	210	TH020160	1,080	10d	10d x 1½"	THF20157	1,045	10d	10d x 1½"	SKH2024L/R	1,015	10d	10d x 1½"
	360	TH023160	1,230	10d	10d x 1½"	THF23160	1,260	10d	10d x 1½"	SKH2324L/R	1,110	10d	10d x 1½"
	560	TH035160	1,430	10d	10d x 1½"	THF17157-2	1,460	10d	10d	SKH414L/R1	1,460	16d	16d

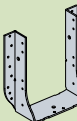
Joist		Double Joist—Top Flange				Double Joist—Face Mount ⁽¹⁾			
									
Depth	TJI®	Hanger	Capacity (lbs)	Nailing		Hanger	Capacity (lbs)	Nailing	
				Header	Joist			Header	Joist
9½"	110	TH035950	2,010	10d	10d x 1½"	THF17925-2	1,350	10d	10d
	210	TH020950-2	2,330	16d	10d	THF20925-2	1,350	10d	10d
11⅞"	110	TH035118	2,050	10d	10d x 1½"	THF17112-2	1,575	10d	10d
	210	TH020118-2	2,610	16d	10d	THF20112-2	1,575	10d	10d
	360	TH023118-2	2,765	16d	10d	THF23118-2	1,800	10d	10d
	560	BPH71118	3,185	16d	10d	HD7120	2,175	16d	10d
14"	110	TH035140	2,100	10d	10d x 1½"	THF17140-2	2,170	10d	10d
	210	TH020140-2	2,330	16d	10d	THF20140-2	2,250	10d	10d
	360	TH023140-2	2,765	16d	10d	THF23140-2	2,370	10d	10d
	560	BPH7114	3,185	16d	10d	HD7140	2,720	16d	10d
16"	210	TH020160-2	2,330	16d	10d	—	—	—	—
	360	TH023160-2	2,765	16d	10d	THF23160-2	2,520	10d	10d
	560	BPH7116	3,185	16d	10d	HD7160	2,925	16d	10d

Joist	Variable Slope Seat Connector ⁽⁵⁾			
				
TJI®	Hanger	Capacity (lbs)	Nailing	
			Header	Joist
110	TMP175	1,150	10d	10d x 1½"
	TMPH175	1,945	10d	10d x 1½"
210	—	—	—	—
360	TMP23	1,785	10d	10d x 1½"
	TMPH23	1,945	10d	10d x 1½"
560	TMP4	1,970	10d	10d x 1½"
	TMPH4	1,945	10d	10d x 1½"

Support Requirements

- Support material assumed to be iLevel™ engineered lumber or sawn lumber (Douglas fir or southern pine species).
- Minimum support width for single- and double-joist top mount hangers is 3" (1½" for ITT hangers).
- Minimum support width for face mount hangers with 10d and 16d nails is 1¾" and 2", respectively.

Footnotes:

- Face mount hanger capacities may be increased up to 15% for snow roofs or 25% for non-snow roofs. Maximum increase for LSSU, LSSUI, and LSSH hangers is 15%.
- VPA connectors are allowed on slopes of 3/12 through 12/12 only.
- LSSU, LSSUI and LSSH hangers can be field adjusted for slopes and skews of up to 45 degrees. Additional lateral restraints are required for 16" deep TJI® joists.
- Miter cut is required at end of joist.
- TMP connectors are allowed on slopes of 1/12 through 6/12 only, and TMPH connectors are allowed on slopes of 6/12 through 12/12 only.

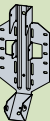
Joist		Variable Slope Seat Joist Hanger ⁽¹⁾⁽³⁾			
					
TJI®	Hanger	Capacity (lbs)		Nailing	
		Sloped Only	Sloped and Skewed	Header	Joist
110	LSSH179	1,120	1,120	10d	10d x 1½"
210	LSSH20	1,120	1,120	10d	10d x 1½"
360	LSSH23	1,120	1,120	10d	10d x 1½"
560	LSSH35	1,595	1,595	16d	10d x 1½"

See General Notes on page 22



WE CAN HELP YOU BUILD SMARTER.

At iLevel, our goal is to help you build solid and durable homes by providing high-quality residential building products and unparalleled technical and field support.

Floors and Roofs: Start with the best framing components in the industry: our Silent Floor® joists; Trus Joist® rim board; and TimberStrand® LSL, Microllam® LVL, and Parallam® PSL headers and beams. Pull them all together with our durable Structurwood® roof sheathing and self-gapping Structurwood Edge® or Structurwood Edge Gold® floor panels. For homeowners who are building their custom dream home, you can upgrade to our premium FrameWorks® Floor System.

Walls: Get the best value out of your framing package — use TimberStrand® LSL studs for tall walls, kitchens, and bathrooms, and our traditional, solid-sawn lumber everywhere else. Cut down installation time by using TimberStrand® LSL headers for doors and windows, TimberStrand® LSL 45-degree columns for precision corners, and our Structurwood® wall sheathing with its handy two-way nail lines.

Software Solutions: If you are a design professional or lumber dealer, iLevel offers a full array of software packages to help you specify individual framing members, create cut lists, manage inventories—even help you design whole-house framing solutions. Contact your iLevel representative to find out how to get the software you need.

Technical Support: Need technical help? iLevel has one of the largest network of engineers and sales representatives in the business. Call us for help, and a skilled member from our team of experts will contact you within one business day to evaluate and help solve your structural frame problems—GUARANTEED.

CONTACT US

1.888.iLevel8 (1.888.453.8358)

www.iLevel.com

iLevel@weyerhaeuser.com

2910 East Amity Road (83716)

P.O. Box 8449

Boise, ID 83707-2449

208.364.3600

OUR GUARANTEE

iLevel TRUE JOIST
Silent Floor® Joist
HOMEBUYER'S GUARANTEE

We guarantee that the iLevel® True Joist® products used in your home have been manufactured to precise tolerances and are free from defects in material and workmanship, to the utility extent that your iLevel® True Joist® Silent Floor® joist develops squeaks or any other problem caused by such defects, and provided that your floor joists have been properly installed, we will promptly remedy that problem at no cost to you.

In addition, if you call us with a problem that you believe may be caused by our products, our representative will contact you within one business day to evaluate the problem and help solve it. **Guaranteed.**

This guarantee is effective for the life of your home.

1-888-453-8358

Weyerhaeuser

April 2006
Reorder TJ-4001

This guide supersedes all previous versions. If this guide is more than one year old, contact your dealer or iLevel rep.
NW

e-Rim®, FrameWorks®, Microllam®, Parallam®, Performance Plus®, Silent Floor®, TimberStrand®, TJ-Beam®, TJJ®, TJ-Xpert®, and Trus Joist® are registered trademarks and iLevel™, Pro™, and TJ-YardMate™ are trademarks of Weyerhaeuser Company. © 2006 Weyerhaeuser Company. All rights reserved. Printed in the USA on Weyerhaeuser Cougar Opaque, 80#.

If it's not Cougar, it's a copycat™

10
COUGAR, NOW WITH 10% RECYCLED CONTENT